



April 16<sup>th</sup>, 2012

Collegewide Masterplanning

# St. Petersburg/Gibbs Campus





- + Campus Location
- + Front Door
- + Pedestrian Access
- + Vehicular Access
- + Parking Information
- + Site Analysis
- + Master Plan
- + Material Palette
- + Outdoor Student Gathering Spaces
- + Signage
- + Conclusion







### Views of the James E. Hendry Administration Building from Intersection of 66<sup>th</sup> Street North & 5<sup>th</sup> Avenue North





## Front Door

### East Entrance at 66<sup>th</sup> Street North



# Collegewide Masterplanning St. Petersburg/Gibbs Campus

Front Door

Entrance at 5<sup>th</sup> Avenue North





# Collegewide Masterplanning **St. Petersburg/Gibbs Campus**

**Front Door**

**West St. Petersburg Community Library Entrance at 8<sup>th</sup> Avenue North**









## Pedestrian Access

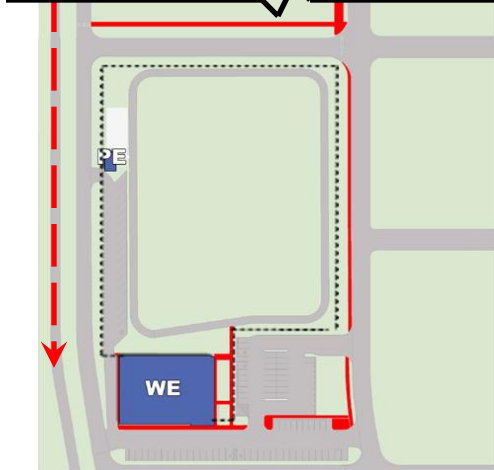
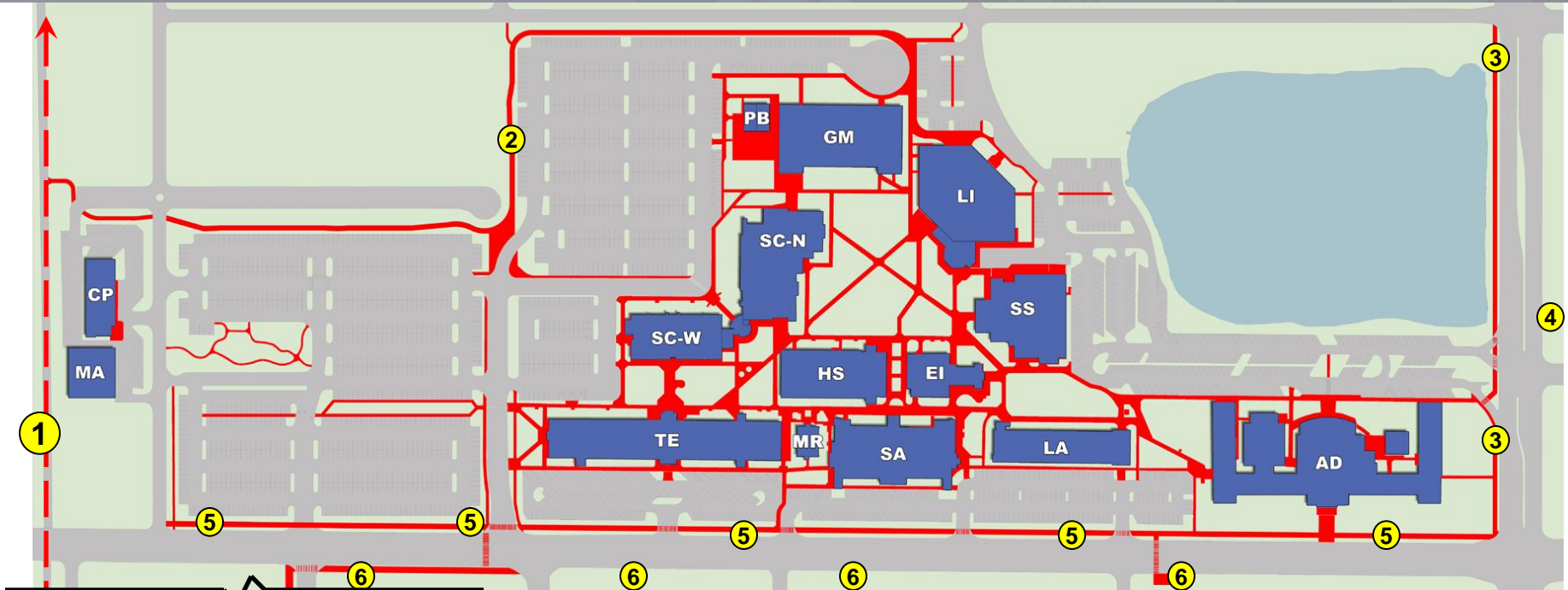

1. Pinellas Trail
2. Access to Pinellas Trail
3. PSTA Bus Stop – 79 Williams Park
4. PSTA Bus Stop – 79 US 19
5. PSTA Bus Stop – 5 Tyrone Mall
6. PSTA Bus Stop – 5 Williams Park

 Sidewalks





## Vehicular Access

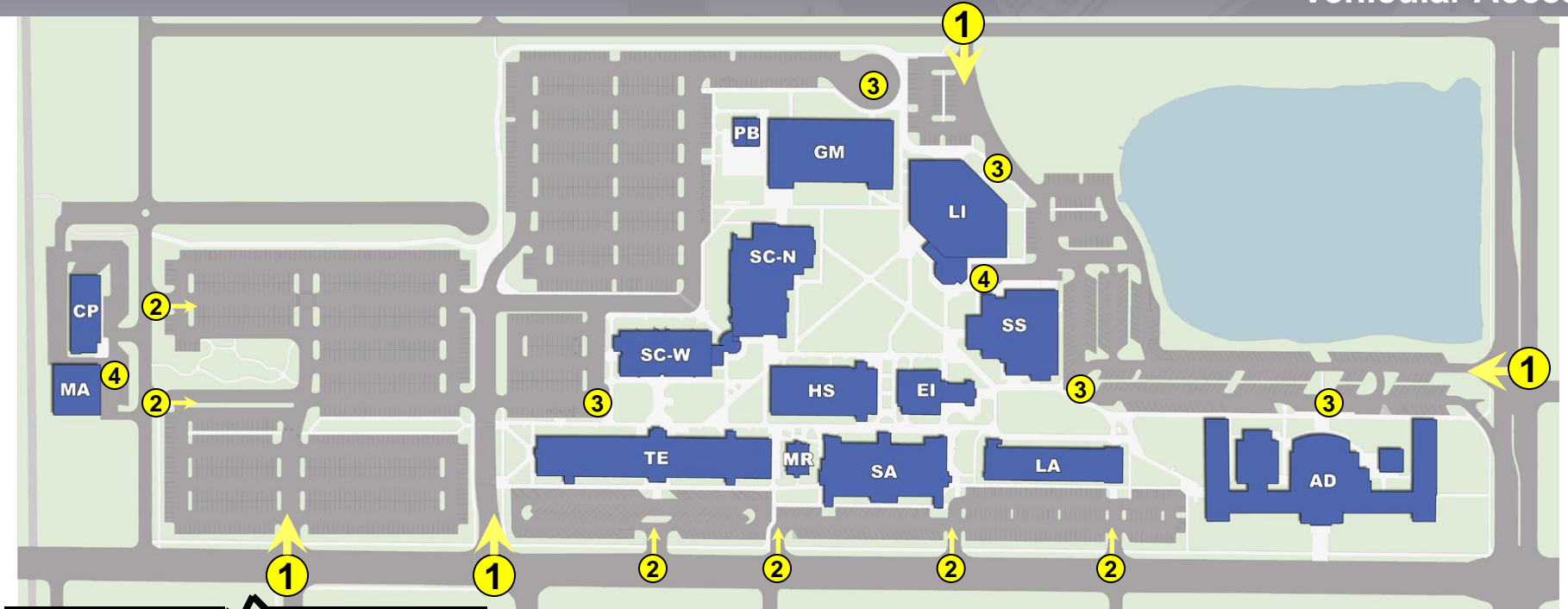

- 1. Primary Access
- 2. Secondary Access
- 3. Drop Off Locations
- 4. Service / Receiving Locations





**Parking Information**

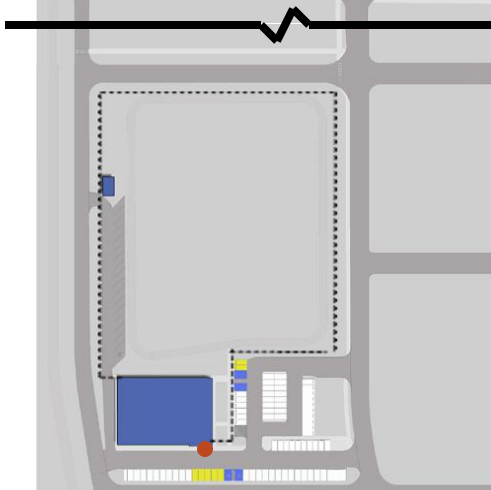

Color	Designation	# of Spaces Main Campus	# of Spaces Wellness Site
Yellow	<b>Staff</b> <sup>1</sup>	<b>170</b>	<b>7</b>
Green	<b>Student</b>	<b>1489</b>	<b>68</b>
Blue	<b>Visitor</b>	<b>110</b>	<b>0</b>
Light Blue	<b>Handicapped</b> <sup>2</sup>	<b>53</b>	<b>4</b>
Purple	<b>HOV</b>	<b>4</b>	<b>0</b>
Dark Purple	<b>Hybrid</b>	<b>4</b>	<b>0</b>
Orange	<b>Motorcycle</b>	<b>31</b>	<b>0</b>
Red	<b>Bicycle</b>	<b>9 racks</b>	<b>1 rack</b>

1. The count does not include parking at Chiller Plant for Facilities Services Staff & Vehicles.

2. The count exceeds the amount of Handicapped Parking Spaces required.





Site Analysis

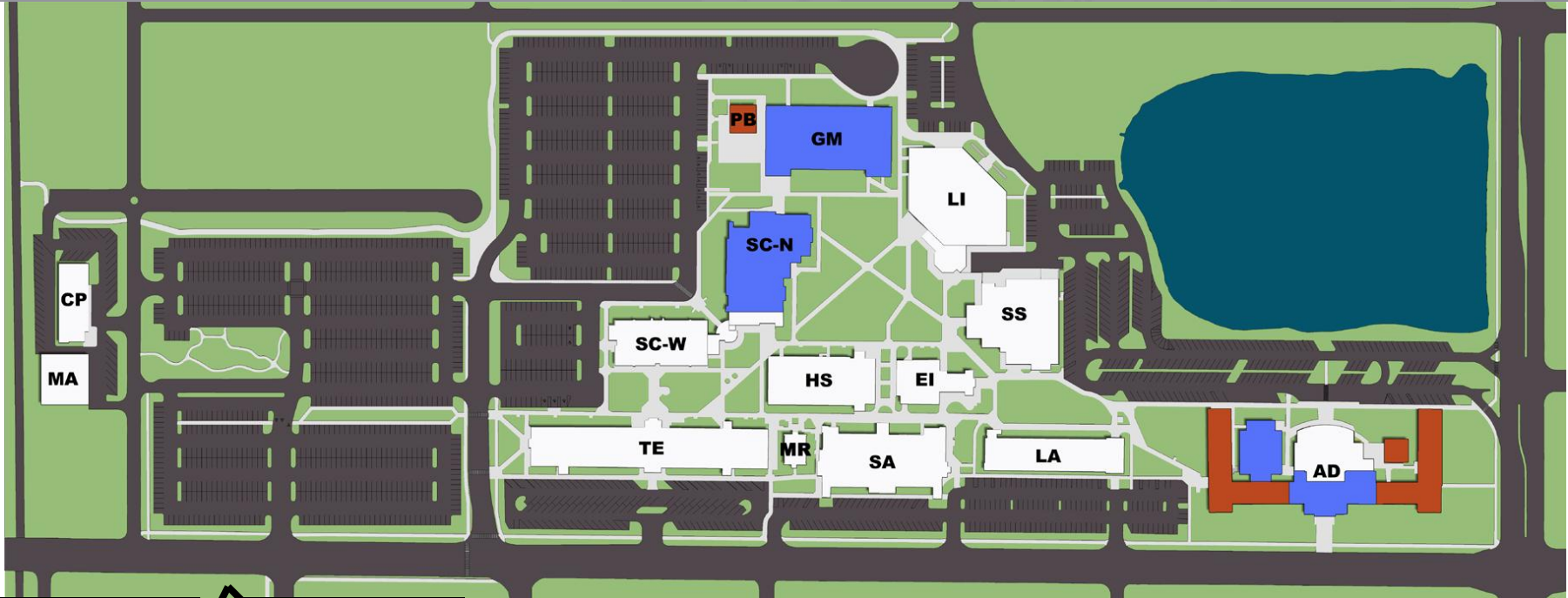

Color	Description	Buildings
	New or existing buildings to remain	MA, CP, TE, SC-W, HS MR, SA, EI, LI, SS, LA, MC
	Existing buildings In need of renovation and updating	AD-Original , GM, SC-N
	Existing buildings to be demolished	AD-East & West Wings, WE, PB, PE





**Site Analysis - Square Footage Summary**

Existing Buildings	Bldg ID	Year Built	Year(s) Renovate	Buildings to Remain (sf)	Buildings In Need Of Updating & Renovation (sf)	Buildings to Demo (sf)
<b>AD – James E. Hendry Administration Building</b>	<b>1</b>					
Original Administration		1941	n/a		11,951	
East & West Wing		1941	n/a			32,391
Campus Meeting Center		1990	n/a			1,460
Map Center		1990	n/a		6,751	
Music Center		1998	n/a	14,862		
<b>LA – Language Arts</b>	<b>2</b>	<b>1957</b>	<b>1993</b>	<b>26,565</b>		
<b>SS – Student Services</b>	<b>3</b>	<b>2009</b>	<b>n/a</b>	<b>44,055</b>		
<b>HS – Humanities</b>	<b>4</b>	<b>1957</b>	<b>1994</b>	<b>15,655</b>		
<b>TE – W. Richard Johnston Technical Building</b>	<b>5</b>	<b>1960</b>				
East Wing			1995	23,328		
West Wing			2002	28,500		
<b>SC – Natural Science</b>	<b>6</b>	<b>2004</b>				
North Wing			1988		41,099	
West Wing			2003	39,600		
<b>GM – Gymnasium</b>	<b>7</b>	<b>1957</b>	<b>n/a</b>		<b>25,524</b>	
<b>LI – West St. Petersburg Community Library</b>	<b>8</b>	<b>2005</b>	<b>2002</b>	<b>54,320</b>		
<b>MA – Maintenance Building</b>	<b>10</b>	<b>2003</b>	<b>n/a</b>	<b>7,053</b>		
<b>SA – Philip Benjamin Social Arts Building</b>	<b>11</b>	<b>1963</b>	<b>1999</b>	<b>58,538</b>		
<b>WE – Wellness Center</b>	<b>13</b>	<b>1967</b>	<b>n/a</b>			<b>19,808</b>
<b>ET – Ethics Institute</b>	<b>14</b>	<b>1959</b>	<b>1994</b>	<b>13,514</b>		
<b>MR – Music Industry Recording Arts</b>	<b>16</b>	<b>1992</b>	<b>2010</b>	<b>2,382</b>		
<b>PE – Storage</b>	<b>17</b>	<b>1967</b>	<b>n/a</b>			<b>288</b>
<b>CH – Chiller Plant</b>	<b>20</b>	<b>1996</b>	<b>1996</b>	<b>7,587</b>		
<b>PB – Portable 119</b>	<b>119</b>	<b>1989</b>	<b>2004</b>			<b>852</b>
<b>SF Subtotal</b>				<b>335,959</b>	<b>85,325</b>	<b>54,799</b>

Total Existing SF of Campus: 476,083



Master Plan - Existing Conditions

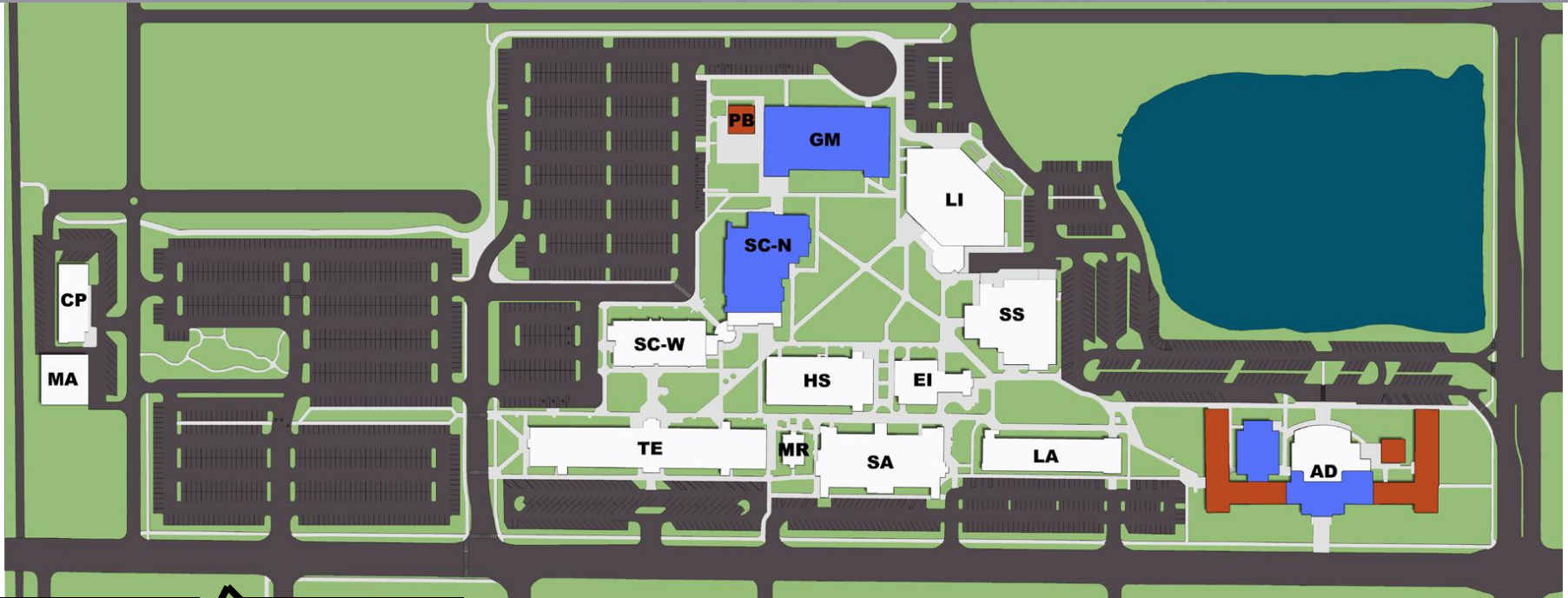

Color	Description
	New or Existing buildings to remain
	Existing buildings in need of renovation and updating
	Existing buildings to be demolished





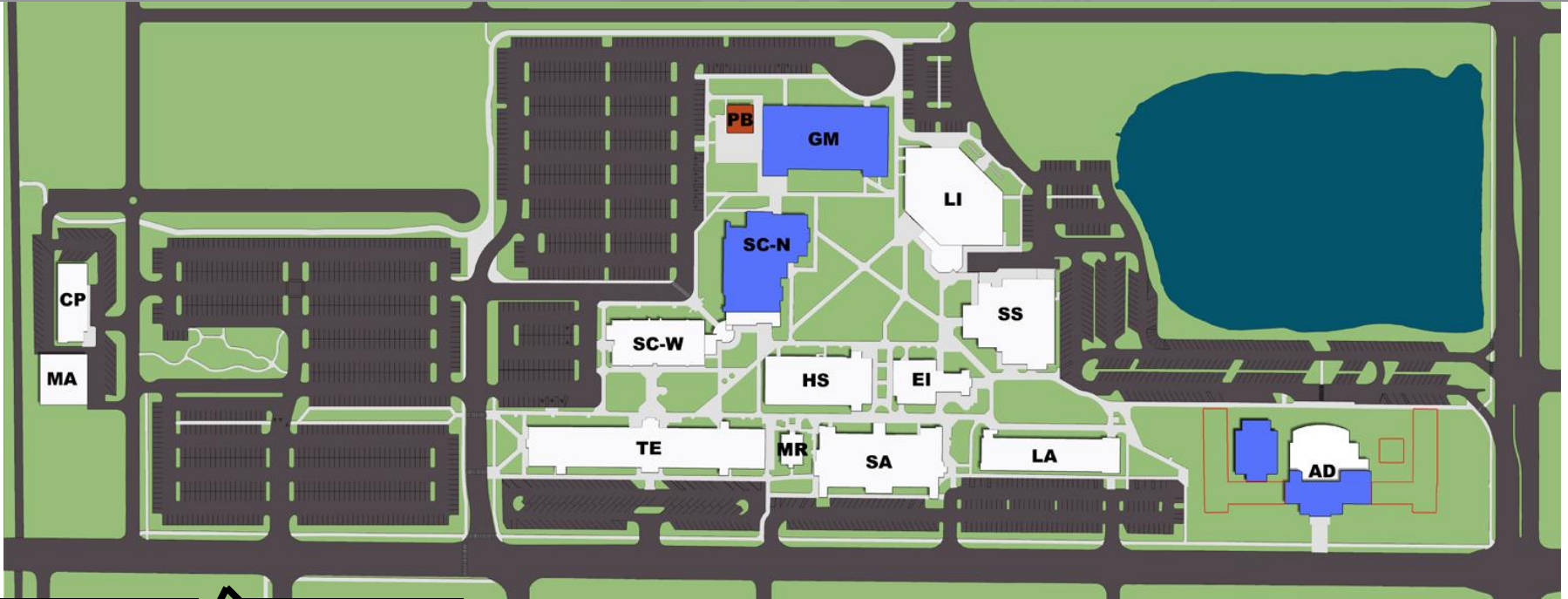

### PHASE ONE

Item	Description
1	Selective Demolition of Administration (AD) Building
2	Remodel Existing Administration (AD) Building
3	Build New Student Support Services Building (50,000 gsf)





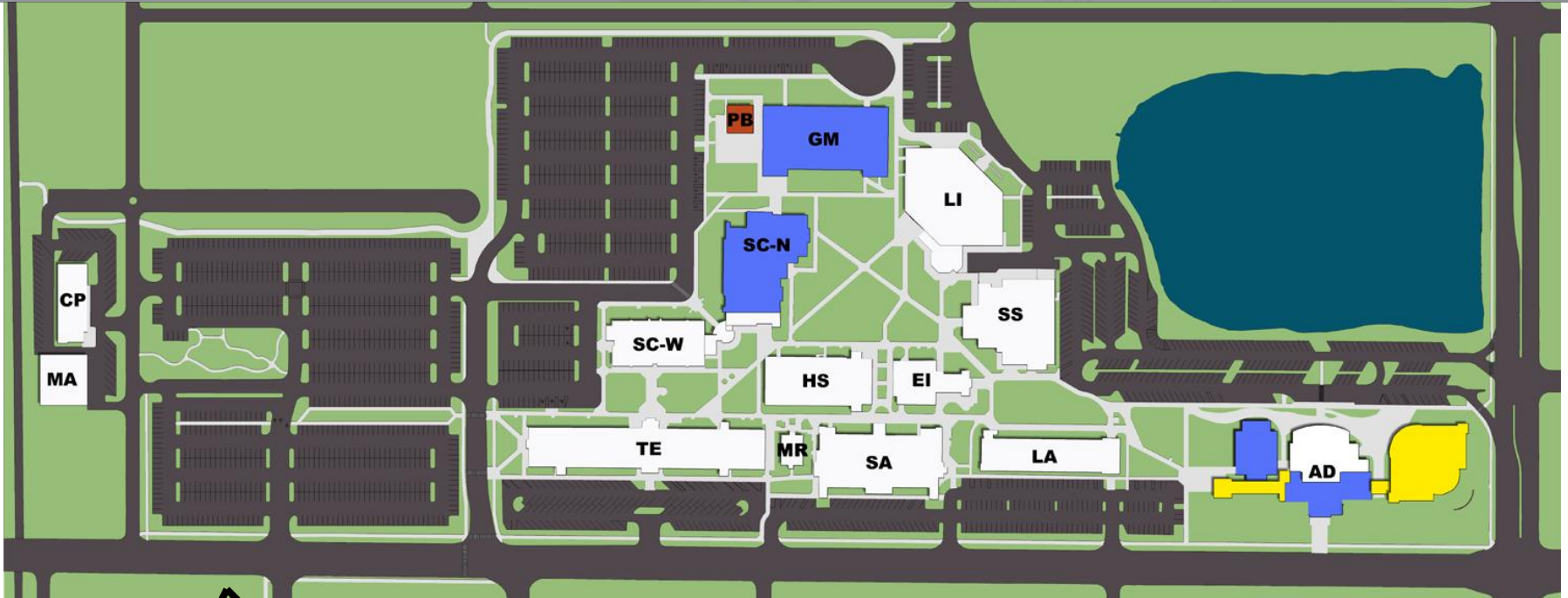

## PHASE ONE

Item	Description
1	Selective Demolition of Administration (AD) Building
2	Remodel Existing Administration (AD) Building
3	<b>Build New Student Support Services Building (50,000 gsf)</b>



**Master Plan – Phase 1**

**Student Support Services Building  
Design Study  
View from 66<sup>th</sup> Street & 5<sup>th</sup> Avenue**





## Master Plan – Phase 1

### Student Support Services Building Design Study Concept Floor Plans

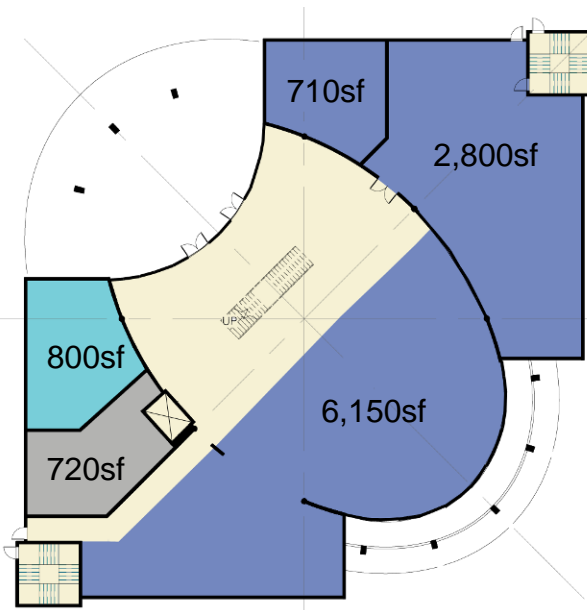

First Floor

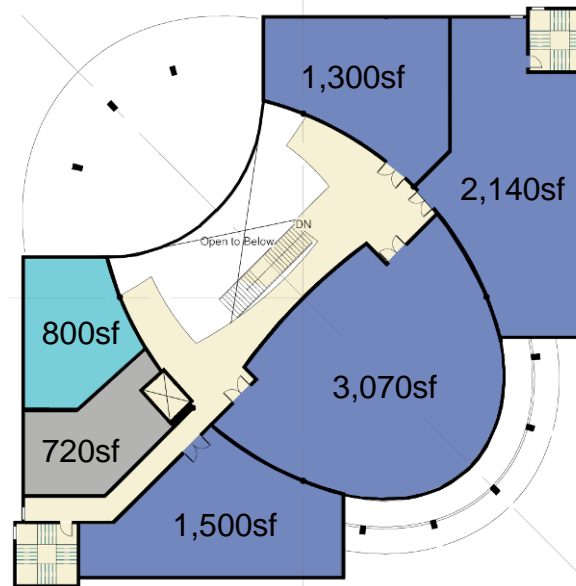

Second Floor

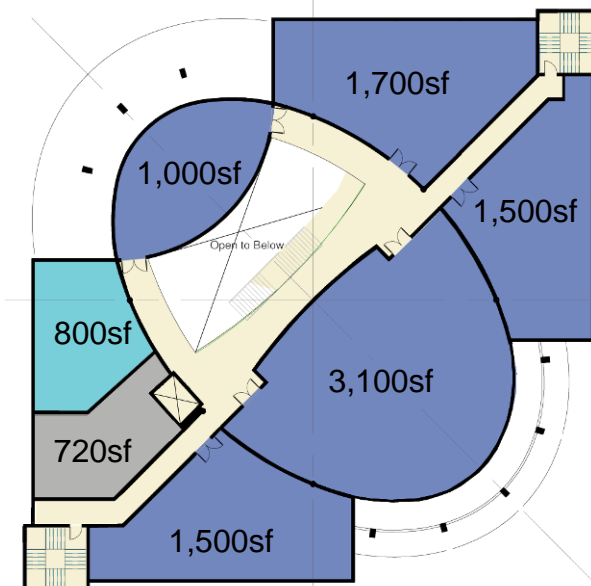

Third Floor

**Master Plan – Phase 1**

**Student Support Services Building  
Design Study  
View from Lake**





**Master Plan – Phase 1**

**Student Support Services Building  
Design Study  
New Pedestrian Plaza**



# Collegewide Masterplanning St. Petersburg/Gibbs Campus

## Master Plan – Phase 1

**Student Support Services Building  
Design Study  
Restoration of James E. Hendry Administration Building**





## Master Plan – Phase 1

### Student Support Services Building Design Study Interior Concept View



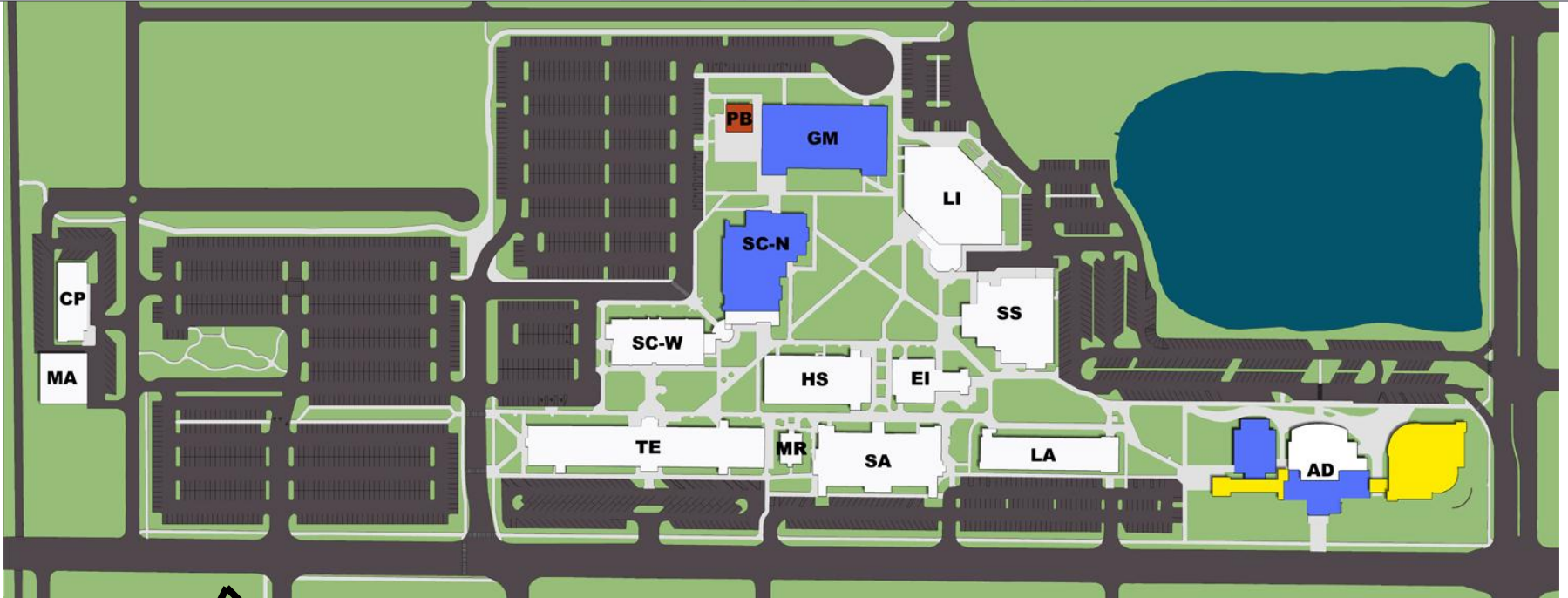

## PHASE TWO

Item	Description
1	Renovation/Remodel of Natural Science – North (SC-N) Building





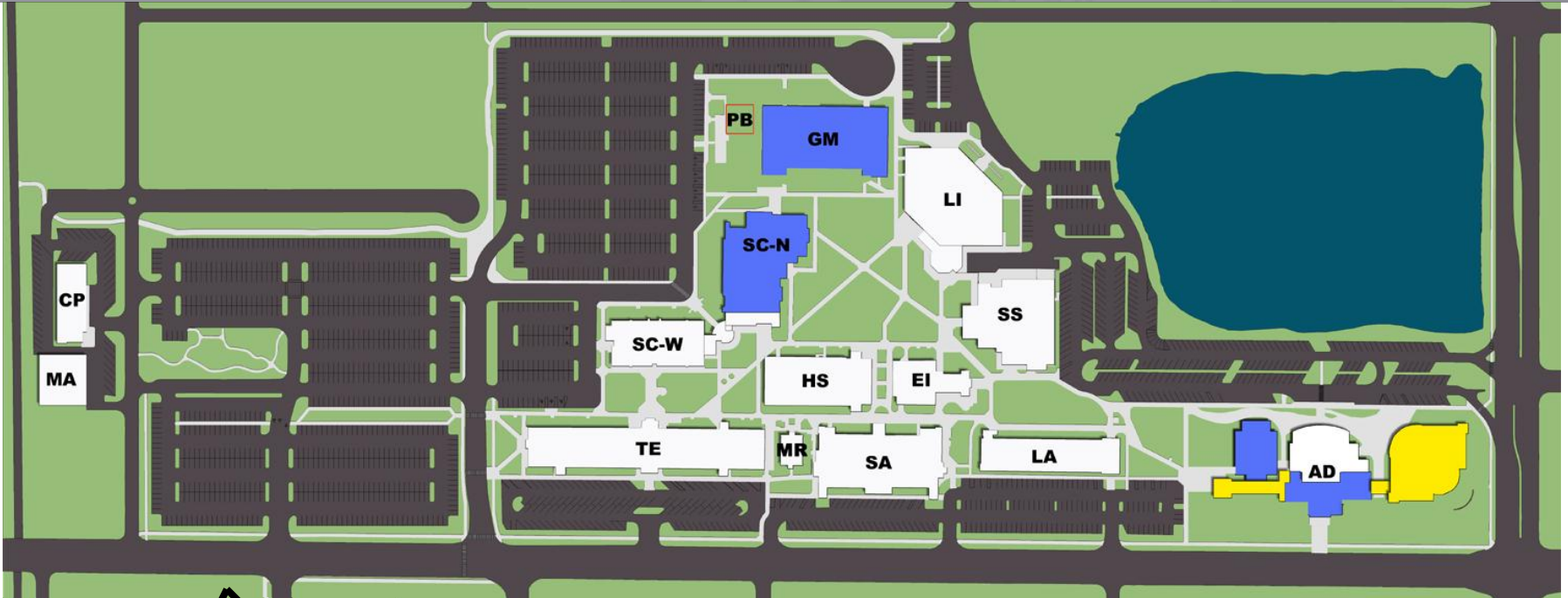

### PHASE THREE

Item	Description
1	Demolition of Portable (PB) Building
2	Remodel Gymnasium (GM)
3	Add Wellness Center to existing Gymnasium (40,000 gsf)



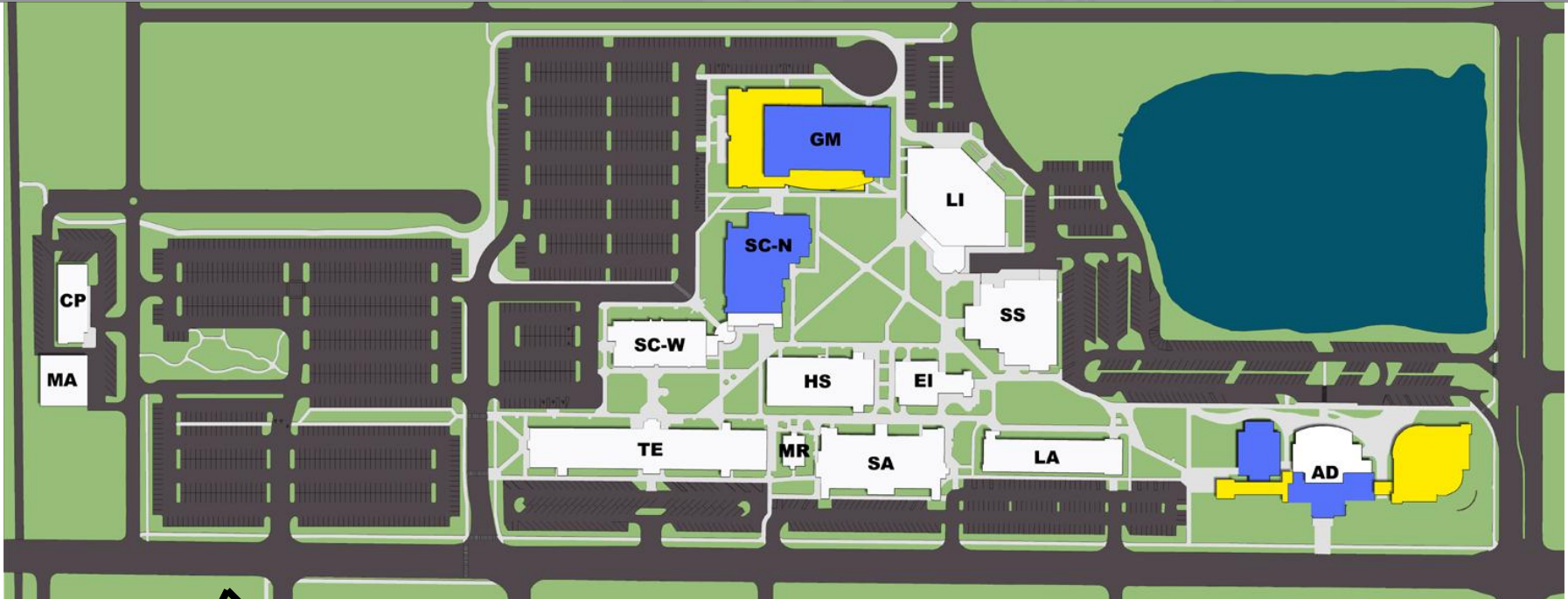

### PHASE THREE

Item	Description
1	Demolition of Portable (PB) Building
2	Remodel Gymnasium (GM)
3	Add Wellness Center to existing Gymnasium (40,000 gsf)





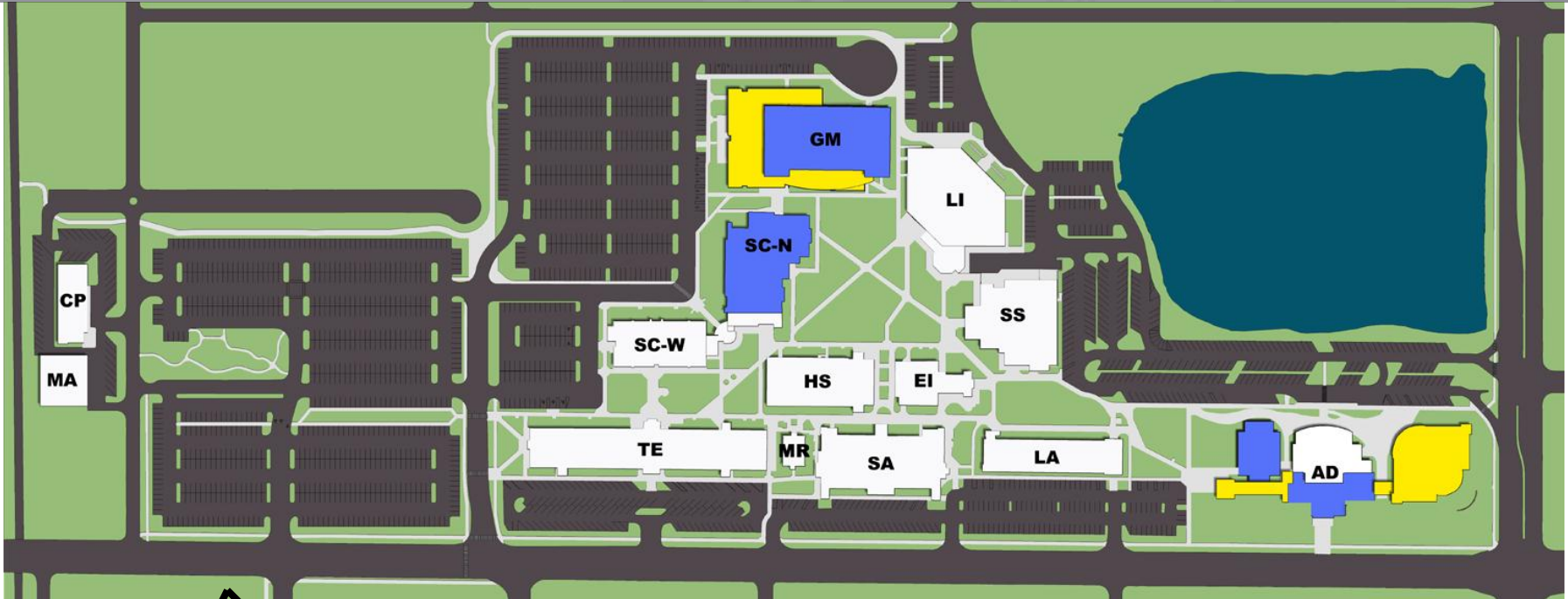

## PHASE FOUR

Item	Description
1	Demolition Existing Wellness Center (WE)
2	Demolition of PE Building
3	Build New Academic Building at current wellness site (50,000gsf)



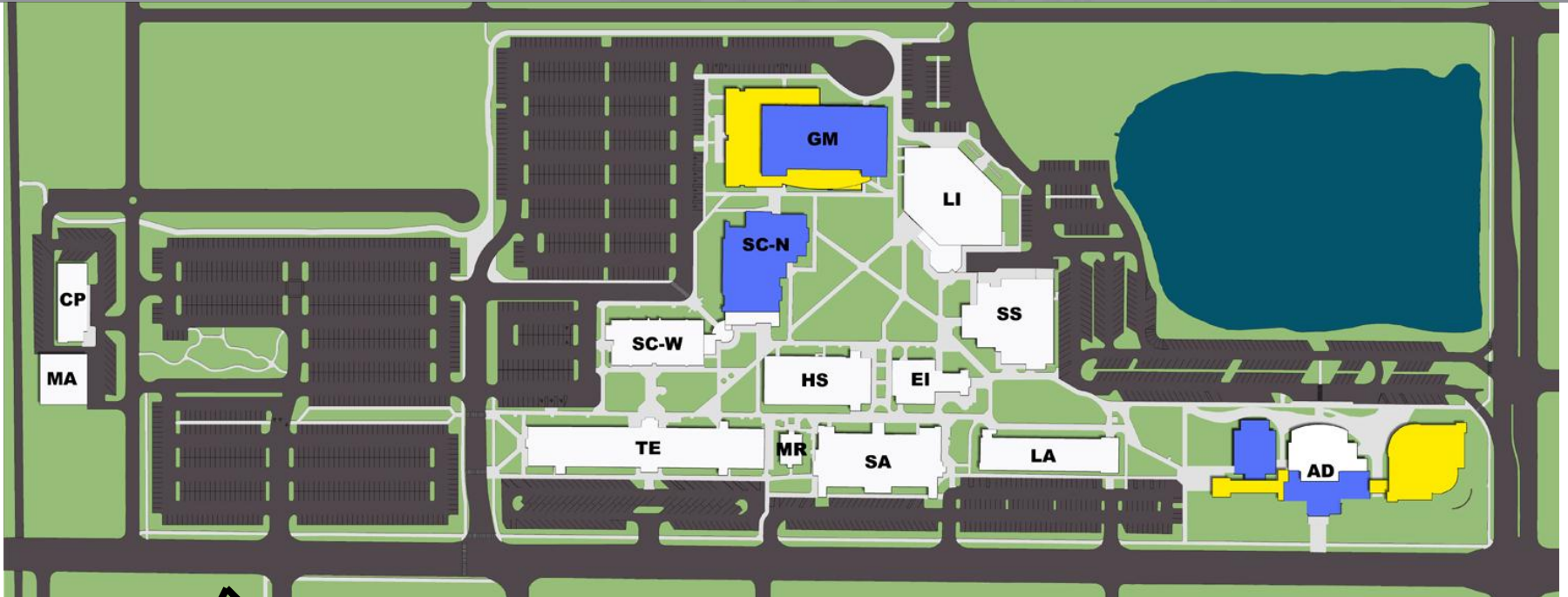

## PHASE FOUR

Item	Description
1	Demolition Existing Wellness Center (WE)
2	Demolition of PE Building
3	<b>Build New Academic Building at current wellness site (50,000gsf)</b>







**Square Footage Summary**

<b>Total Existing Square Footage of Campus:</b>	<b>476,083</b>	
<b>Total Square Footage to be Demolished:</b>	<b>- 54,799</b>	
<b>Existing Square Footage Remaining:</b>		<b>421,284 gsf</b>
<b>New Buildings to be Constructed in the Future</b>		
<b>Student Support Services Building</b>	<b>50,000</b>	
<b>Wellness Center Addition to Existing Gymnasium</b>	<b>40,000</b>	
<b>New Academic Building on Existing Wellness Site</b>	<b>+ 50,000</b>	
<b>Total</b>		<b>140,000 gsf</b>
<b>New Grand Total</b>		<b>561,284 gsf</b>
<b>Total SF Gained based on Master Plan Build out (140,000 - 54,799)</b>		<b>85,201 gsf</b>



# Collegewide Masterplanning St. Petersburg/Gibbs Campus

## Master Plan 3D View

	New Construction
	Renovated/Remodeled
	Existing Buildings





	New Construction
	Renovated/Remodeled
	Existing Buildings







**Student Services Building**  
Brick Details & Painted Stucco



**Natural Science Building**  
Blue Metal Roofs



**W. Richard Johnston Technical Building**  
Brick Detail & Glass



**West St. Petersburg Community Library**  
Brick Detail & Painted Stucco





**Humanities Building Entry**  
Blue Metal Roof & Contemporary Collegiate Gothic Detail



**W. Richard Johnston Technical Building Entry**  
Red Brick & Painted Stucco



**Philip Benjamin Social Arts Building**  
Red Brick, White Stucco & Blue Metal Roof



**West St. Petersburg Community Library & Food Service**  
Red Brick, Painted Stucco & Blue Metal Roof



## Outdoor Student Gathering Spaces



**Students in Quad near the West St. Petersburg Community Library & Food Service**



**Central Quad Area Facing the Humanities Building**

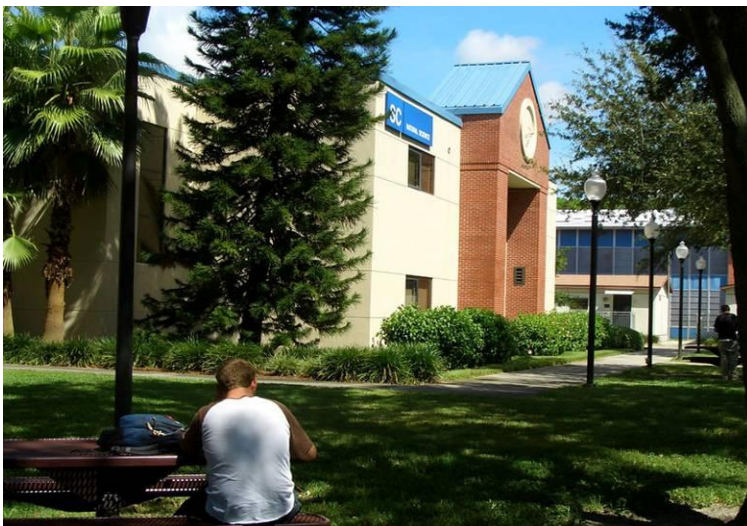

**Student Studying in Quad Near the Natural Science Building**



**West St. Petersburg Community Library Entrance facing the Quad**



## Outdoor Student Gathering Spaces



**Picnic Tables near the Natural Science Building**



**Outdoor Seating near the Ethics Institute Building**



**Students Gathering in between the Ethics Institute and the Humanities Building**



**Monumental Signs located throughout the campus**



**Electronic Signage located at the Quad**



**Building Identification Sign Example  
at the Student Services Building**



**Directional Maps located throughout the campus**



- **The campus is landlocked and has been built out.**
- **Much of the campus has been remodeled/ renovated or newly built over the past 20 years.**
- **There are expansion possibilities at the Gymnasium.**
- **The Board of Trustees has identified the Administration Building for renovation and replacement and the addition of a new Student Support Services building connected to the original Administration Building.**