

2013-14 Student Planner and Handbook



Within Reach

St. Petersburg College

SPC



Mission Statement

Promote student success and enrich our communities through education, career development and self-discovery

Within Reach

St. Petersburg College

SPC

www.spcollege.edu



Name _____

Address _____

City, State, ZIP Code _____

Phone _____

Student number _____

13-0170-01

This handbook is intended to enhance your college experience. Inside you will find helpful tips on resources available to you to help you succeed. You also will find a calendar to help you plan your school related activities.

SPC makes it easy for you to keep up with important information by posting deadline reminders, event promotions, weather alerts, college closing and a variety of information on campus and online:

- College Website – www.spcollege.edu
- Social media (Facebook, Twitter, YouTube and more) – www.spcollege.edu/social
- SPC student email – www.spcollege.edu/email
- Emergency alerts - www.spcollege.edu/Emergency_Alert_System

This handbook also contains some SPC Rules and Policies. For a complete list of SPC's Board of Trustee Rules and Procedures please go to www.spcollege.edu/boardrules. Thank you for choosing St. Petersburg College.

For SPC information: 727-341-4772

Mailing address: PO Box 13489, St. Petersburg FL 33733-3489

Aug. 19-Dec. 6, 2013

April	22	Monday	Special Programs FALL Registration for FALL Classes
	24	Wednesday	OPEN Registration for FALL Classes
May	24	Friday	Incoming Transient Student Registration for FALL Classes
June	17	Tuesday	Deadline for International applicants to fulfill requirements
July	13	Saturday	Priority apply deadline for bachelor programs
August	5	Monday	Priority apply deadline for regular session
	15	Thursday	Faculty report for duty (8/15 through 8/16)
	16	Friday	Registration BEGINS: Senior Citizen & State Employee – Regular Classes
	19	Monday	First day of classes: Regular, 1st 8-Week Mod, Online NOTE: NO REGISTRATION ALLOWED AFTER 1ST CLASS MEETING
	23	Friday	Last day to drop, receive refund and/or change to audit: Regular, 1st 8-Week Mod, Online
	23	Friday	First day of Weekend classes NOTE: NO REGISTRATION ALLOWED AFTER 1ST CLASS MEETING
September	2	Monday	COLLEGE CLOSED - Labor Day
	13	Friday	Registration BEGINS: Senior Citizen & State Employee – Express Classes
	16	Monday	First day of Express classes NOTE: NO REGISTRATION ALLOWED AFTER 1ST CLASS MEETING
	19	Thursday	Last day to withdraw with a grade of "W": 1st 8-Week Mod Classes
	20	Friday	Last day to drop, receive refund and/or change to audit: Express Classes
	October	11	Friday
11		Friday	Midterm exams for Online classes BEGIN
11		Friday	(4 P.M.) Final grades due in PS for 1st 8-Week Mod Classes
13		Sunday	Midterm exams for Online classes END
14		Monday	First day of classes: 2nd 8-Week Mod NOTE: NO REGISTRATION ALLOWED AFTER 1ST CLASS MEETING
18		Friday	Last day to drop, receive refund and/or change to audit: 2nd 8-Week Mod classes
22		Tuesday	COLLEGE CLOSED – COLLEGE DAY – NO CLASSES
23		Wednesday	Last day to withdraw with a grade of "W": Weekend Classes
24		Thursday	Last day to withdraw with a grade of "W": Regular & Online Classes
November	1	Friday	Deadline for name in graduation program
	4	Monday	Last day to withdraw with a grade of "W": Express Classes
	11	Monday	COLLEGE CLOSED – Veteran's Day
	16	Saturday	Last day to withdraw with a grade of "W": 2nd 8-Week Mod Classes
	27	Wednesday	COLLEGE CLOSED – Thanksgiving Break 11/27-12/1

SPC ACADEMIC CALENDAR

FALL TERM 2013-14

December	5	Thursday	Final exams BEGIN: Weekend Classes
	6	Friday	Last day of classes: Regular, Online, Express, 2nd 8-Week Mod
	7	Saturday	Last day of Weekend classes
	7	Saturday	Final exams END: Weekend Classes
	9	Monday	Final exams BEGIN: Regular & Express Classes
	12	Thursday	Final exams END: Regular & Express Classes
	12	Thursday	Last day late applications taken for graduation – Term I
	13	Friday	(4 p.m.) Final grades due in PS: Regular, Online, Express, 2nd 8-Wk Mod
	13	Friday	Last day for Faculty
	14	Saturday	Commencement
	19	Thursday	STUDENT Winter Break begins: NO CLASSES UNTIL 1/13/14
	19	Thursday	FACULTY Winter Break begins: FACULTY RETURN 1/9/14
	19	Thursday	COLLEGE CLOSED UNTIL 1/1/14 -STAFF Winter Break 12/19/13-1/1/14

SPC ACADEMIC CALENDAR

SPRING TERM 2013-14

Jan. 13-May 2, 2014

October	28	Monday	Deadline for International applicants to fulfill requirements
	28	Monday	Special Programs Registration begins
	30	Wednesday	OPEN Registration BEGINS: Regular, Online, Express, 1st & 2nd 8-Week Mod
November	8	Friday	Priority apply deadline for bachelor programs
	29	Friday	Incoming Transient Student Registration for Spring Classes
December	30	Monday	Priority apply deadline for regular session
January	10	Friday	Faculty report for duty
	10	Friday	Registration BEGINS: Senior Citizen & State Employee – Regular Classes
	13	Monday	First day of classes: Regular, 1st 8-Week Mod, Online NOTE: NO REGISTRATION ALLOWED AFTER 1ST CLASS MEETING
	17	Friday	Last day to drop, receive refund and/or change to audit: Regular, 1st 8-Week Mod, Online
	17	Friday	First day of Weekend classes NOTE: NO REGISTRATION ALLOWED AFTER 1ST CLASS MEETING
	20	Monday	COLLEGE CLOSED - Martin Luther King Jr.'s Birthday observed
	24	Friday	Last day to drop, receive refund and/or change to audit: Weekend classes

Calendar subject to change. For an updated calendar of academic events visit us at www.spcollege.edu/calendar.

February	7	Friday	Registration BEGINS: Senior Citizen & State Employee – Express Classes
	10	Monday	First day of Express classes NOTE: NO REGISTRATION ALLOWED AFTER 1ST CLASS MEETING
	13	Thursday	Last day to withdraw with a grade of "W": 1st 8-Week Mod Classes
	14	Friday	Last day to drop, receive refund and/or change to audit: Express Classes
March	7	Friday	Last day of classes: 1st 8-Week Mod
	7	Friday	(4 P.M.) Final grades due in PS for 1st 8-Week Mod Classes
	10	Monday	COLLEGE CLOSED - SPRING BREAK (3/10-3/15)
	17	Monday	First day of classes: 2nd 8-Week Mod NOTE: NO REGISTRATION ALLOWED AFTER 1ST CLASS MEETING
	21	Friday	Midterm exams for Online classes BEGIN
	21	Friday	Last day to drop, receive refund and/or change to audit: 2nd 8-Week Mod classes
	23	Sunday	Midterm exams for Online classes END
	24	Monday	Last day to withdraw with a grade of "W": Weekend Classes
	26	Wednesday	Last day to withdraw with a grade of "W": Regular & Online Classes
	28	Friday	Deadline for name in graduation program
April	6	Sunday	Last day to withdraw with a grade of "W": Express Classes
	17	Thursday	Last day to withdraw with a grade of "W": 2nd 8-Week Mod Classes
	18	Friday	COLLEGE CLOSED --SPRING HOLIDAY
May	1	Thursday	Final exams BEGIN: Weekend Classes
	2	Friday	Last day of classes: Regular, Online, Express, 2nd 8-Week Mod
	3	Saturday	Final exams END: Weekend Classes
	3	Saturday	Last day of Weekend classes
	5	Monday	Final exams BEGIN: Regular & Express Classes
	8	Thursday	Final exams END: Regular & Express Classes
	8	Thursday	Last day late applications taken for graduation – Term II
	9	Friday	(4 p.m.) Final grades due in PS: Regular, Online, Express, 2nd 8-Wk Mod
	9	Friday	Last day for Faculty
		TBD	Commencement

May 19-July 22, 2014

March	21	Friday	Deadline for International applicants to fulfill requirements
	24	Monday	Special Programs Registration begins
	26	Wednesday	OPEN Registration BEGINS: Regular, Online, Express, 1st 8-Week Mod
April	25	Friday	Incoming Transient Student Registration for Summer Classes
May	5	Monday	Priority apply deadline for regular session
	16	Friday	Registration BEGINS: Senior Citizen & State Employee – Regular Classes
	19	Monday	Faculty report for duty
	19	Monday	First day of classes: Regular, 1st 8-Week Mod, Online NOTE: NO REGISTRATION ALLOWED AFTER 1ST CLASS MEETING
	23	Friday	Last day to drop, receive refund and/or change to audit: Regular, 1st 8-Week Mod, Online
	26	Monday	COLLEGE CLOSED - Memorial Day observed
June	13	Friday	Registration BEGINS: Senior Citizen & State Employee – Express Classes
	13	Friday	Deadline for name in graduation program
	16	Monday	First day of Express classes NOTE: NO REGISTRATION ALLOWED AFTER 1ST CLASS MEETING
	18	Wednesday	Last day to drop, receive refund and/or change to audit: Express Classes
	19	Thursday	Last day to withdraw with a grade of "W": 1st 8-Week Mod Classes
	20	Friday	Midterm exams for Online classes BEGIN
	22	Sunday	Midterm exams for Online classes END
	28	Saturday	Last day to withdraw with a grade of "W": Regular and Online Classes
July	4	Friday	COLLEGE CLOSED – Fourth of July holiday
	9	Wednesday	Last day to withdraw with a grade of "W": Express Classes
	11	Friday	Last day of classes: 1st 8-Week Mod
	11	Friday	(4 P.M.) Final grades due in PS: 1st 8-Week Mod classes
	18	Friday	Final exams BEGIN: Online Classes
	20	Sunday	Final exams END: Online Classes
	22	Tuesday	Last day of classes: Regular, Express & Online Classes
	23	Wednesday	Final exams BEGIN: Regular & Express Classes
	24	Thursday	Final exams END: Regular & Express Classes
	24	Thursday	Last day late applications taken for graduation – Term III
	25	Friday	Last day for Faculty
	25	Friday	(4 p.m.) Final grades due in PS: Regular, Express & Online Classes
	26	Saturday	Commencement

TABLE OF CONTENTS

SPC Student Snapshot.....	83
SPC locations	84
Campus contacts (Includes phone numbers, services, program directors and activities at each site)	
Allstate Center.....	85
Caruth Health Education Center	87
Clearwater Campus	89
EpiCenter	92
Seminole Campus.....	93
St. Petersburg/Gibbs Campus.....	95
SPC Downtown	98
SPC Midtown.....	101
Tarpon Springs Campus.....	102
Veterinary Technology Center	104
Academics	105
Registration.....	108
Student Life.....	109
Student Services.....	110
Financial Aid	112
Student's Right-to-Know.....	114
Additional online resources	116

The Board of Trustees of St. Petersburg College affirms its equal opportunity policy in accordance with the provisions of the Florida Educational Equity Act and all other relevant state and federal laws, and regulations. The college will not discriminate on the basis of race, color, ethnicity, religion, sex, age, national origin, marital status, sexual orientation, gender identity, genetic information or against any qualified individual with disabilities in its employment practices or in the admission and treatment of students. Recognizing that sexual harassment constitutes discrimination on the basis of sex and violates this Rule, the college will not tolerate such conduct. Should you experience such behavior, please contact the director of EA/EO at 727-341-3261; by mail at P.O. Box 13489, St. Petersburg, FL 33733-3489; or by e-mail at eaao_director@spcollege.edu.

Age – Fall 2012

Students 24 and younger.....	49.4%
Students 25 and older.....	50.6%
Average age of A.A. students.....	24
Average age of A.S. students.....	31
Average age of Baccalaureate students.....	34
Average age of all students.....	29

(Source: Tables 11A, 11B, 12 & 13, Fact Book 2012-13)

Gender – Fall 2012

Female.....	58.9%
Male.....	38.5%
Not disclosed.....	2.6%

(Source: SPC Pulse, 1/11/13)

Ethnicity – Fall 2012

African-American.....	13.1%
White.....	67.5%
Hispanic.....	9.3%
Asian.....	3.5%
American-Indian.....	0.4%
Pacific Islander.....	2%
Multiple races.....	1.5%
Not reported.....	4.6%

(Source: Table 9A, Fact Book 2012-13)

Residency – Fall 2012

In-state.....	97.4%
Out-of-state.....	2.6%

(Source: Table 6, Fact Book 2012-13)

Percentage of students continuing studies beyond SPC – Fall 2012

A.A. students.....	74.7%
A.S. students.....	2.1%

(Source: Table 34, Fact Book 2012-13)

2011-2012 Annual Enrollment (headcount)

Credit.....	45,914
Non-Credit.....	16,622
Total.....	62,536

(Source: Table 28, Fact Book 2012-13)

School and work – Fall 2012

Part-time students.....	70.5%
Full-time students.....	29.5%
Average student load.....	8.2 credits

(Source: Tables 4 & 7, Fact Book 2012-13)

About our instructors

Of the 404 instructional employees, 139 hold doctoral degrees, while 131 have master's degrees and 103 have a master's plus 30 additional credit hours in their discipline.

School mascot: Titans

In Greek mythology, the Titans were a family of giants who ruled the Earth. Today, the term titan represents one who is gigantic in size or power or who stands out for greatness of achievement.

School colors and motto

SPC's colors are blue and white, representing the qualities of truth and light. The college's motto, "Lux et Veritas" is Latin for (you guessed it) light and truth.

Accreditation

St. Petersburg College is accredited by the Commission on Colleges of the Southern Association of Colleges and Schools to award selected bachelor's degrees in science and bachelor's degrees in applied science; associate degrees in arts, associate degrees in science; as well as certificates and applied technology diplomas. Contact the Commission on Colleges at 1866 Southern Lane Decatur, Georgia 30033-4097, or call 404-679-4500 for questions about the accreditation of St. Petersburg College.

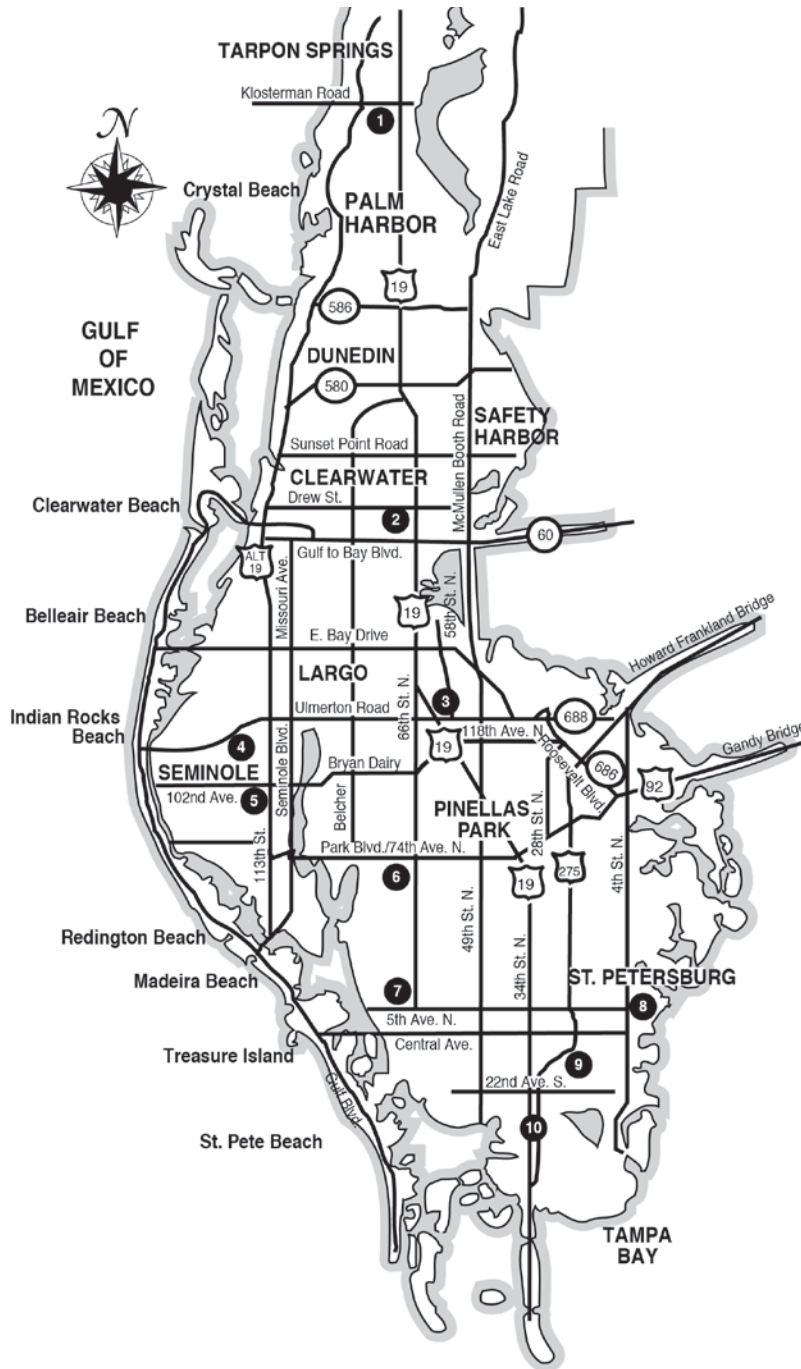

- 1 Tarpon Springs Campus
600 Klosterman Road
Tarpon Springs
- 2 Clearwater Campus
2465 Drew St.
Clearwater
- 3 EpiCenter
13805 58th St. N
Clearwater
- 4 Veterinary Technology Center
12376 Ulmerton Road
Largo
- 5 Seminole Campus
9200 113th St. N
Seminole
- 6 Health Education Center
7200 66th St. N
Pinellas Park
- 7 St. Petersburg/Gibbs Campus
6605 Fifth Ave. N
St. Petersburg
- 8 SPC Downtown
244 Second Ave. N
St. Petersburg
- 9 SPC Midtown
1048 22nd St. S
St. Petersburg
- 10 Allstate Center
3200 34th St. S
St. Petersburg

ALLSTATE CENTER

Administration

Campus Executive Officer
J.C. Brock.....727-341-4495

Academic Contacts

Criminal Justice Academies
Brian Frank, Dean.....727-341-4143
Criminal Justice Crime Scene Program
David Brumfield.....727-341-4508
Criminal Justice Indoor Range
L.P. Miller.....727-341-4471
Criminal Justice
Michael Hughes.....727-341-4146
Digital Forensics
Kevin Thomas.....727-341-4540
Emergency Administration/Management
Charles Crowther.....727-341-4507
Fire Academy
Jim Terry.....727-302-6852
Fire Science
Charles Crowther.....727-341-4507
Multijurisdictional Counterdrug Training (MCTFT)
Eileen LaHaie.....727-341-4432
National Terrorism Preparedness Institute (NTPi)
Eileen LaHaie.....727-341-4432
RCPI Grant (COPS)
Eileen LaHaie.....727-341-4432

Bachelor's degree

Public Safety Administration
Brian Frank, Dean.....727-341-4143

Advising (by appointment)

Criminal Justice, Emergency Management, Fire
Science, Crime Scene, Digital Forensics
Location: AC 227 A
Phone:727-341-4456
Public Safety Administration, B.A.S.
Location: AC 227 C
Phone:727-341-4419

Student Services

Admissions, Business Office, Registration,
Student Records
Location: AC 100
Hours: Mon. and Thurs. 8:30 a.m.-5 p.m.
Tues. and Wed. 8:30 a.m.-4:30 p.m.
Fri. 8:30 a.m.-3:30 p.m.
Phone:727-341-4444

Disabilities Resources

Services provided on the St. Petersburg/Gibbs
Campus
Ray Hollowell.....727-341-4316

Financial Aid

Phone:727-791-2485

Fitness Center

Location: AC 127

Food Service

Vending machines, Andy Hines Student Center

Library

Location: AC 202
Hours: Mon.-Thurs. 3:30-7 p.m.
Phone:727-341-4486

Lost and Found

Location: East entrance Security Desk
Phone:.....727-341-4436

Photo ID/Library Card

Location: East entrance – Security desk
Phone:727-341-4436

Student Lounge

Location: AC 124

Student Life and Leadership

Location: AC 114
Phone:727-341-4480

Parking

Location: East entrance – Security desk
Phone:727-341-4436

Veterans Services

Services provided on the St. Petersburg/Gibbs
Campus
Location: AD 120
Larry Hobbs.....727-341-4271

Women on the Way (WOW)

Services provided on these campuses:
Clearwater Campus.....727-791-2634
SPC Midtown727-341-7156

CARUTH HEALTH EDUCATION CENTER

7200 66th St. N
Pinellas Park

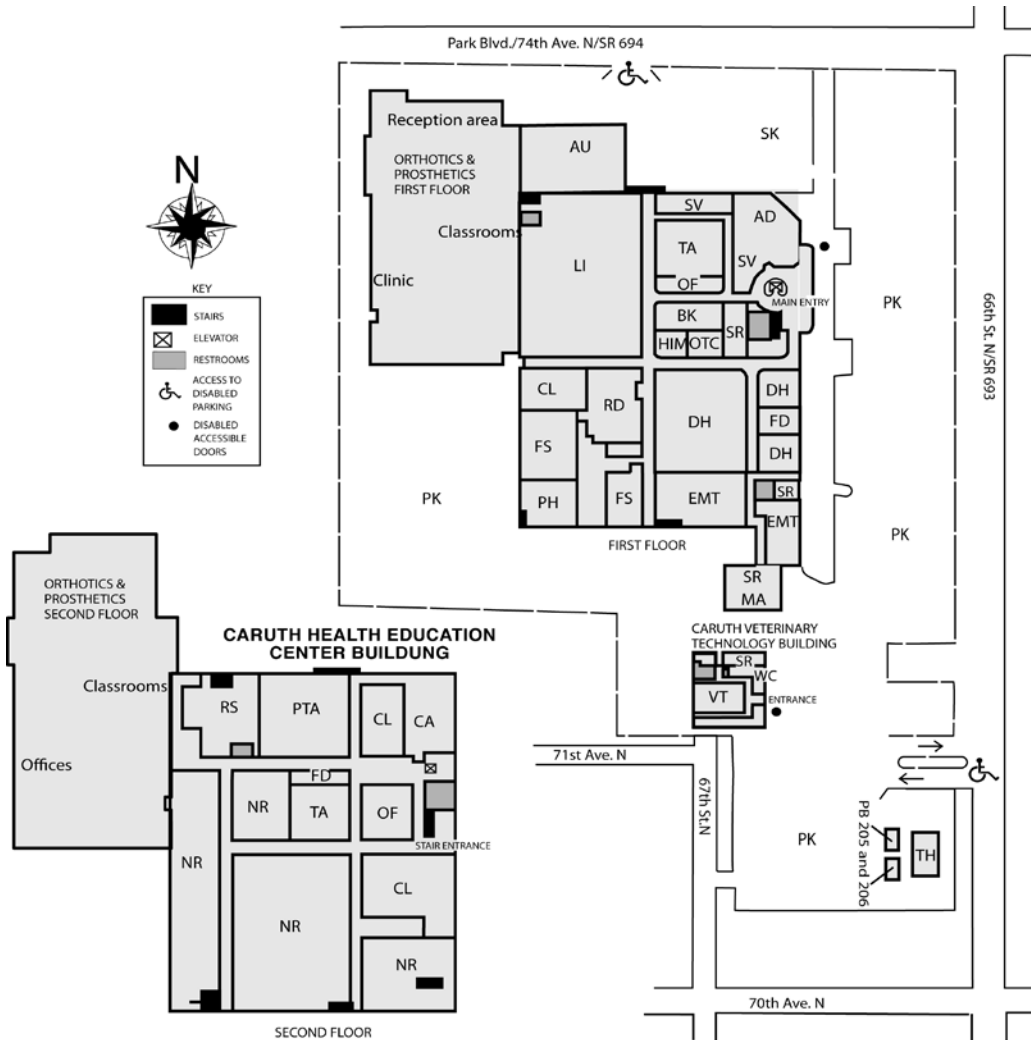

Caruth Health Education Center Room Codes

- | | | |
|-------------------------------------|------------------------------------|----------------------------|
| AD - Administration | LI - Library | SK - Staff parking |
| AU - Auditorium | MA - Maintenance | SR - Storage |
| BK - Bookstore | NR - Nursing | SV - Student Services |
| CA - Cafeteria | OF - Offices | TA - Teaching Auditorium |
| CL - Classrooms | OTC - OSSD testing center | TH - Thrift Store |
| DH - Dental Hygiene | PB - Portables 205 and 206 | VT - Veterinary Technology |
| EMT - Emergency Medical Technology | PH - Physical Plant/Receiving | WC - Wellness Center |
| FD - Faculty development | PK - Student parking | |
| FS - Funeral Services | PTA - Physical Therapist assistant | |
| HIM - Health Information Management | RS - Respiratory Therapy | |

CARUTH HEALTH EDUCATION CENTER

Administration

Provost
Phil Nicotera727-341-3666
Associate Provost
Nancy Kelley.....727-341-3602

Academic Contacts

Dental Hygiene
Joan Tonner727-341-3671
Emergency Medical Services
Nerina Stepanovsky727-341-3680
Funeral Services
Kevin Davis727-341-3781
Health Information Management
Sheila Newberry727-341-3623
Human Services
Cheryl Kerr727-341-3736
Nursing
Allison Chen 727-341-3700
Geneo Roberts727-341-3625
Physical Therapist Assistant
Rebecca Kramer727-341-3614
Radiography
John Fleming.....727-341-3758
Respiratory Care
Steve Mikles.....727-341-3627

Bachelor's degrees

Health Sciences
(Dental Hygiene, Health Services Administration
and Orthotics & Prosthetics)
Rebecca Ludwig, Dean727-341-4150
Nursing
Susan Baker, Dean727-341-3622
Veterinary Technology
Richard Flora, Dean727-302-6721

Academic Support

NIP Learning Support Commons
Location: Room 199
Phone:727-341-3724

Advising

Location: Student Affairs, Room 176
Phone: (messages only).....727-341-3687

Bookstore

Location: Room 184
Phone:727-545-0261

Student Services

Admissions, Business Office, Registration,
Student Records
Location: Records Office – Room 176
Hours: Mon. and Thurs. 8:30 a.m.-7 p.m.
Tues. and Wed. 8:30 a.m.-4:30 p.m.
Fri. 8:30 a.m.-noon
Phone:727-341-3750 or 727-341-3757

Clubs and Organizations

Student Life and Leadership
Location: Room 205 D
Mary Gerst727-341-3471
Orthotics & Prosthetics Student Society
Phi Theta Kappa
Physical Therapist Assistant Club
Radiography Club
Student American Dental Hygienists' Association
Student Caruth Health Information Management
Association
Student Government Association
Student Nurses Association
Veterinary Technician Society

Disabilities Resources

Location: Room 182
Stefanie Silvers.....727-341-3721

Food Service

Location: Room 204

Financial Aid

Phone:727-791-2485

Library

Location: Room 191
Hours: Mon.-Thurs. 7:30 a.m.-9 p.m.
Fri. 7:30 a.m.-4 p.m.
Sat. 10 a.m-5 p.m.
Phone:727-341-3604

Lost and Found

Location: Room 205 D
Phone:727-341-3471

Parking

Location: Security office
Phone:727-341-3654

Photo ID/Library Card

Location: Business Office
Phone:727-341-3747

Student Lounge

Location: Room 204

Veterans Services

Location: St. Petersburg/Gibbs Campus, AD 120
Larry Hobbs727-341-4271

Women on the Way (WOW)

Services provided on these campuses:
Clearwater Campus.....727-791-2634
Seminole Campus.....727-394-6163

CLEARWATER CAMPUS

2465 Drew St.
Clearwater

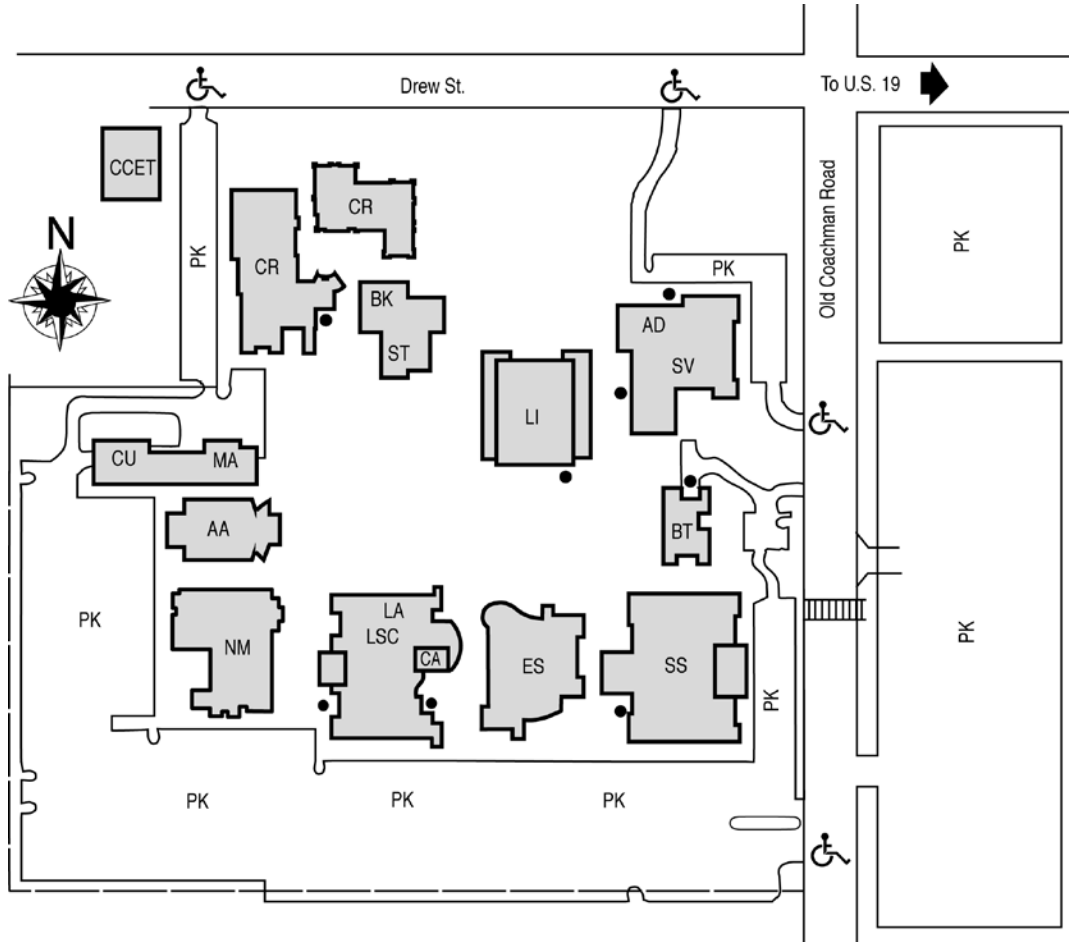

CLEARWATER BUILDING CODES

- AA - Arts Auditorium
- AD - Administration
- BK - Bookstore
- BT - Business Technologies
- CA - Cafe/Food services
- CCET - Collaborative Center for Emerging Technologies
- CR - Crossroads
- CU - Central Utilities
- ES - Ethics and Social Sciences
- LA - Language Arts

- LI - Michael M. Bennett Library
- LSC - Learning Support Commons
- MA - Maintenance
- NM - Natural Science, Math and College of Education
- PK - Student parking
- SS - Social Sciences
- ST - Student Life and Leadership
- SV - Student Services

CLEARWATER CAMPUS

Administration

Provost
Stan Vittetoe..... 727-791-2475
Associate Provost
Matt Bowen.....727-791-2492

Academic Contacts

Business
Roberto Fernandez.....727-712-5770
Computer and Information Technology
Nancy Russell.....727-791-5940
Ethics
Susan Demers, Dean727-791-2501
Humanities and Fine Arts
Jonathan Barnes.....727-791-5997
Communications
Shirley Oakley.....727-791-5904
Math
Jimmy Chang, Dean.....727-791-2542
Natural Sciences
Mike Stumpe.....727-791-2535
Social and Behavioral Sciences
Anja Norman.....727-791-2671

Bachelor's degrees

Biology
John Chapin, Dean727-394-6995
Education
Kimberly Hartman, Dean727-712-5876
Paralegal Studies
Susan Demers, Dean727-791-2501

Academic Support

Learning Support Commons
Location: LA 100
Phone:.....727-791-2674
Computer Labs
Location: LA 100
Phone:727-791-2674
Writing Studio
Location: Library
Hours: Mon.-Thurs. 8 a.m.-8 p.m.
Fri. 8 a.m.-4 p.m.
Sat. 10 a.m.-5 p.m.
Phone:727-791-5994

Advising

Location: Information Desk – AD 101
Phone:.....727-791-2496

Bookstore

Location: ST 108
Hours: Mon. and Thurs. 7:45 a.m.-7 p.m.
Tues. and Wed. 7:45 a.m.-5 p.m.
Fri. 7:45 a.m.-12:30 p.m.
Phone:.....727-791-2624

Student Services

Admissions, Business Office, Registration, Student
Records
Location: AD 161
Hours: Mon. and Thurs. 8:30 a.m.-7 p.m.
Tues. and Wed. 8:30 a.m.-4:30 p.m.
Fri. 8:30 a.m.-noon
Phone:.....727-791-2458 or 727-791-2459

Career Services

Location: AD 115
Rose Mackey727-791-2738

Clubs/Organizations

Student Life and Leadership
Location: ST 130
Stephanie Henningsen:727-791-2622
A.C.E. Club (Disability Awareness)
Art Club
BADEYA (Black Student Union)
Biology Club
Engineering Club
Ethics Club
Film Club
Golden Key International Honor Society
Healthy East Asian Traditions
High Achievers
Honors College Student Consortium
Interdisciplinary Studies Club
International Club
Intervarsity Christian Fellowship
Phi Theta Kappa Honor Society
Positive Directions Association/Woman on the Way
Net Impact Club
Science Adventurers
Silent Titans
Students for Educational Reform
Student Government Association
Student Mentor Club
Theater Club
Toastmasters International
Undergraduate Science Research Society
Veterans Student Association

Disabilities Resources

Location: SS 110
Jeff Ziegler727-791-2710 or 2628

Early College/Dual Enrollment

Location: SS 133
Jeff Cesta727-791-5970
Candy Lazar727-791-5971

Financial Aid

Phone:727-791-2485

Fitness Center

Location: ST 104

Food Service

Location: Hard Drive Café, ES 117
Hours: Mon.-Thurs. 7 a.m.-7 p.m.
Fri. 8 a.m.-1 p.m.
Phone:727-791-2669

CLEARWATER CAMPUS

International Programs

Location: AD 152
Phone:.....727-791-2632

Library

Location: LI
Hours: Mon.-Thurs. 7:30 a.m.-9 p.m.
Fri. 7:30 a.m.-4 p.m.
Sat. 10 a.m.-5 p.m.
Phone:727-791-2614

Lost and Found

Location: ST 130
Phone:.....727-791-2622

Parking

Location: AD 101
Phone:.....727-791-2473

Photo ID/Library Card

Location: Library
Phone:.....727-791-2473

Security

Phone..... 727-791-2560

Student Lounge

Location: ST 113
Phone:.....727-791-2622

Testing

Location: AD 118
Phone:.....727-791-2491

Veterans Services

Location: SS 102
Leta Carreira:.....727-791-2676

Women on the Way (WOW)

Location: BT101
Phone:.....727-791-2634

EPICENTER

13805 58th St. N
Largo



SPC District Office
6021 142nd Ave. N, Largo

EpiCenter – Services
14025 58th St. N, Largo

EpiCenter
13805 58th St. N, Largo

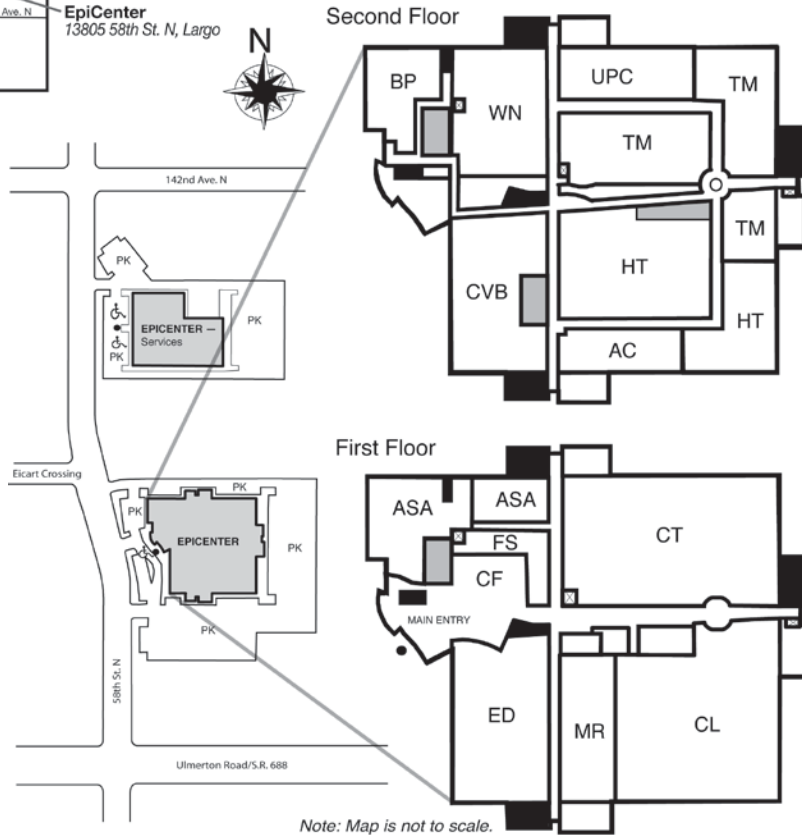

Note: Map is not to scale.

Academic Contacts

Greg Nienstiel, Dean.....727-791-2433

College of Business

- Baccalaureate Programs
 - Business Administration
 - International Business
 - Management and Organizational Leadership
 - Sustainability Management

College of Computer and Information Technology

- Certificate and Associate programs
 - Information Technology (IT) Security
 - Computer Networking
 - Baccalaureate program
 - Technology Management
- Sharon Setterlind, Dean.....727-341-4641



EpiCenter Room Codes

- AC - Pinellas County Arts Council
- ASA - Academic & Student Affairs
- BP - Baccalaureate Programs and University Partnerships
- CF - Cafeteria
- CL - Collaborative Labs
- CT - Corporate Training
- CVB - Pinellas County Convention Center & Visitors Bureau
- ED - Pinellas County Economic Development
- FS - Food service
- HT - High Tech Certificate Program
- MR - Meeting rooms
- TM - Technology Management
- UPC - University Partnership Center
- WN - WorkNet

SEMINOLE CAMPUS

9200 113th St. N
Seminole

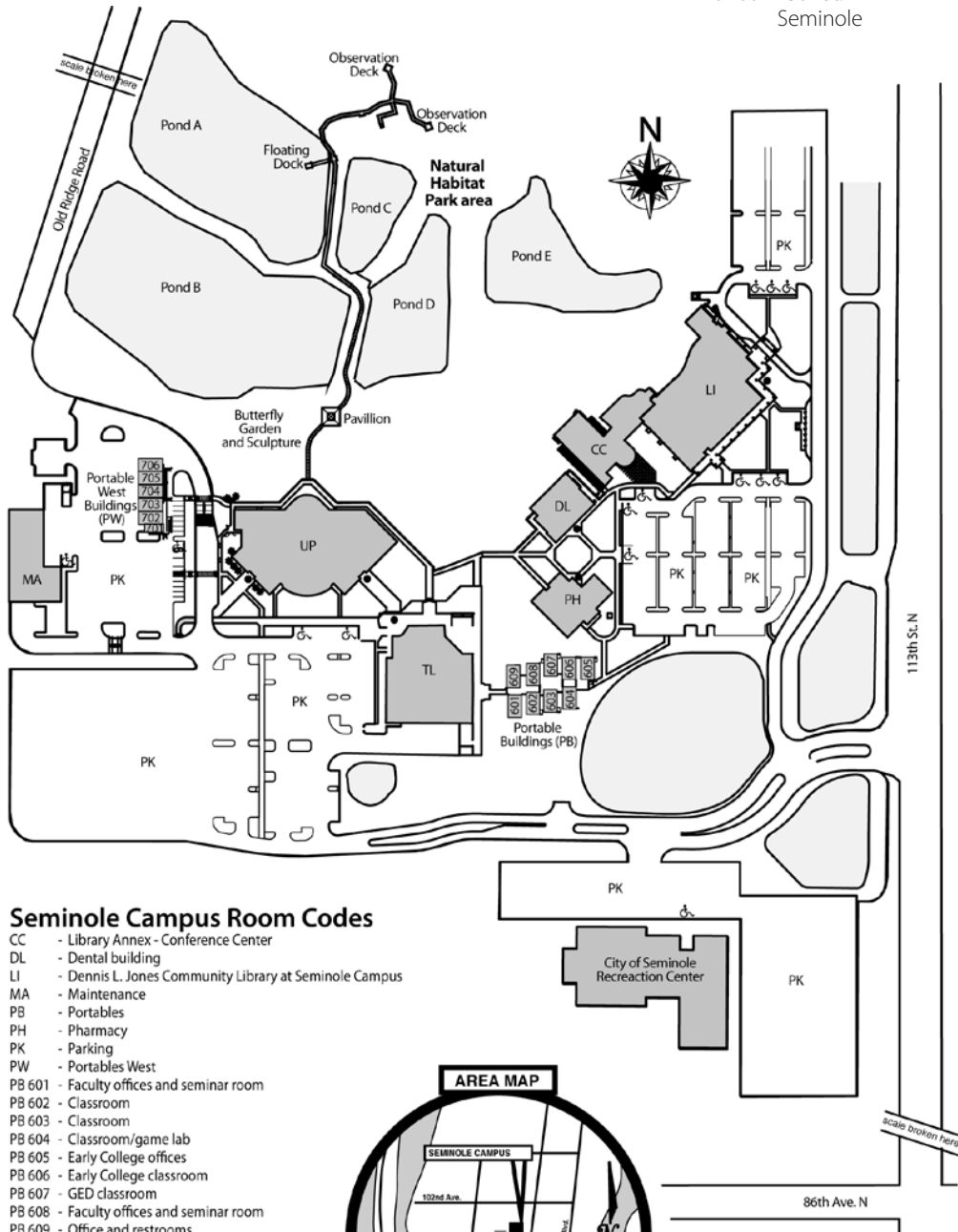

Seminole Campus Room Codes

- CC - Library Annex - Conference Center
- DL - Dental building
- LI - Dennis L. Jones Community Library at Seminole Campus
- MA - Maintenance
- PB - Portables
- PH - Pharmacy
- PK - Parking
- PW - Portables West
- PB 601 - Faculty offices and seminar room
- PB 602 - Classroom
- PB 603 - Classroom
- PB 604 - Classroom/game lab
- PB 605 - Early College offices
- PB 606 - Early College classroom
- PB 607 - GED classroom
- PB 608 - Faculty offices and seminar room
- PB 609 - Office and restrooms
- PW 701 - Restrooms and Drinking Fountains
- PW 702 - Faculty Offices
- PW 703 - Classroom
- PW 704 - Classroom
- PW 705 - Classroom
- PW 706 - Classroom
- TL - Technology Learning
- UP - C.W. Bill Young University Partnership Center building



KEY

- ACCESS TO DISABLED PARKING
- DISABLED ACCESSIBLE DOORS

SEMINOLE CAMPUS

Administration

Provost
 Jim Olliver.....727-394-6111
 Associate Provost
 Lynda Womer.....727-394-6112

Academic Contacts

Business
 Nicolle Panuthos.....727-394-6266
 Communications
 Albert Farr 727-394-6044
 Humanities and Fine Arts
 Kevin Stanley.....727-394-6011
 Math
 Lisa Borzewski727-394-6170
 Natural Sciences
 Amanda Gilleland.....727-394-6024
 Social and Behavioral Sciences
 Sheryl Peterson.....727-394-6948
 A.S. and Certificate Outreach Specialist
 Sandy Decarlo.....727-394-6130

Academic Support

Learning Support Commons
 Location: TL 104
 Phone:.....727-394-6189
 Computer Labs
 Location: Collaborative Commons – UPC 192
 Phone:.....727-394-6103

Advising

Location: UPC 105
 Phone:727-394-6234

Bookstore

Location: UPC Lobby
 Phone:.....727-395-0403

Student Services

Admissions, Business Office, Registration,
 Student Records
 Location: UPC Lobby
 Hours: Mon. and Thurs. 8:30 a.m.-7 p.m.
 Tues. and Wed. 8:30 a.m.-4:30 p.m.
 Fri. 8:30 a.m.-noon
 Phone:727-394-6134

Clubs/Organizations

Student Life and Leadership
 Location: UPC 195
 Dawn Waechter:.....727-394-6158
 Entrepreneurship CEO Chapter Club
 Environmental Club
 Future Teachers Group
 GLOW (Gay, Lesbian or Whatever) Club
 Hospitality Club
 International Club
 Math Club
 Music Club
 Phi Theta Kappa – PTK

Rotaract Club
 Spanish Club
 Student Government Association – SGA
 Student Veterans Association
 (WAVE) Web, Arts & Visual Entertainment Club
 Women on the Way

Disabilities Resources

Location: UPC 110
 Aimee Stubbs.....727-394-6289

Early College/Dual Enrollment

Location: PT 606
 Phone:.....727-394-6164

Financial Aid

Phone:727-791-2485

Food Service

Oasis Café
 Location: First-floor lobby of the UPC
 Location: Library
 Hours: Same as library operating hours

Library

Dennis L. Jones Seminole Community Library at
 St. Petersburg College
 Location: 9200 113th St. N
 Hours: Mon.-Thurs. 7:30 a.m.-9 p.m.
 Fri. 7:30 a.m.-4 p.m.
 Sat. 10 a.m.-5 p.m.
 Sun. 1-5 p.m.
 Phone:727-394-6905

Photo ID/Library Card

Location: Information Commons – TL 104
 Phone:727-394-6133

Testing

Location: UPC 105
 Phone:727-394-6234

University Partnership Center

Location: UPC 203
 Phone:727-394-6200

Parking

Location: Security, UPC 101
 Phone:727-394-6248

Veterans Services

Location: PT 609
 Allison Shenofsky.....727-394-6204

Women on the Way (WOW)

Phone:727-394-6163

ST. PETERSBURG/GIBBS CAMPUS

6605 Fifth Ave. N
St. Petersburg

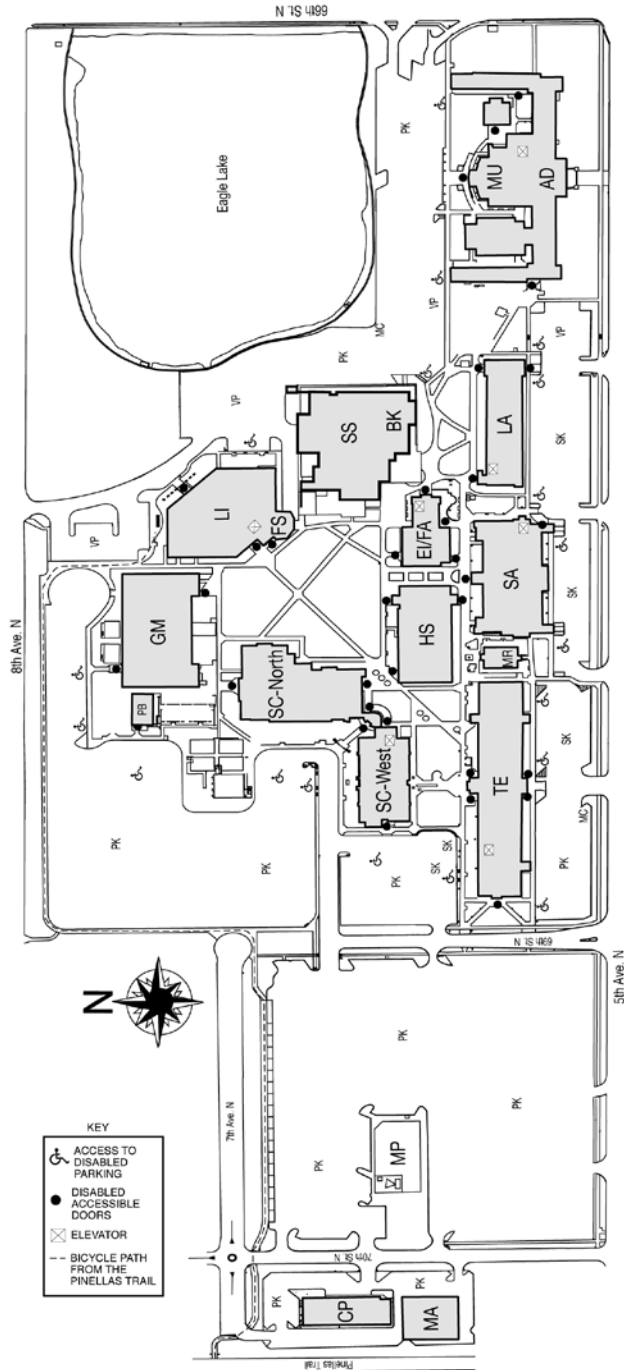

ST. PETERSBURG/GIBBS BUILDING CODES

- AD - James E. Hendry Administration Building
- BK - Bookstore
- CP - Chiller plant
- EI - Ethics Institute
- FS - Food service
- GM - Gymnasium
- HS - Humanities
- LA - Language Arts
- LI - West St. Petersburg Community Library – a Michael M. Bennett Library
- MA - Maintenance
- MC - Motorcycle parking
- MP - Mini park (picnic area)/challenge course
- MR - Music Industry Recording Arts
- MU - Music Center
- PB - Portable 201 - GED Program Building
- PK - Student parking
- RT - Running track
- SA - Philip Benjamin Social Arts Building
- SC - Natural Science
- SK - Staff parking
- SS - Student Services and St. Petersburg Collegiate High School
- TE - W. Richard Johnston Technical Building
- WE - Wellness Center
- VP - Visitor parking

PARKING COLOR CODES

- Handicapped - Blue
- Staff/Faculty - Yellow
- Student - White
- Visitor - Green

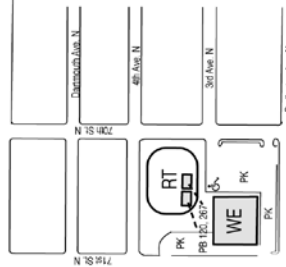
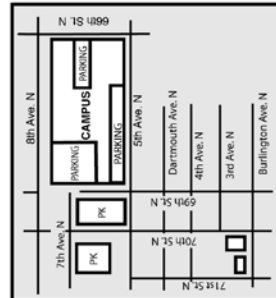

ST. PETERSBURG/GIBBS CAMPUS

Administration

Provost
Karen Kaufman White727-341-4656
Associate Provost
Tyrone Clinton.....727-341-4349

Academic Contacts

Business
Greg Nienstiel, Dean727-791-3026
Michael Ewell.....727-341-3543
Computer and Information Technology
Sharon Setterlind, Dean727-341-4677
Nancy Russell.....727-341-4724
Education
Kimberly Hartman, Dean727-712-5876
Communications
Evelyn Finklea..... 727-341-4369
Ethics
Adeniji Odutola..... 727-341-4313
Humanities and Fine Arts
Nancy Smith.....727-341-4361
Math
Jimmy Chang, Dean727-341-4305
David Kolonoski.....727-341-4757
Natural Sciences
Bev Grundset, Biological727-341-4343
Richard Musgrave, Physical727-341-4379
Social and Behavioral Sciences
Evelyn Finklea.....727-341-3556
A.S. and Certificate Outreach Specialist
Debra Grady-Sheehy.....727-341-4722

Academic Support

Learning Support Commons
Location: TE 200
Phone:.....727-341-3512
Writing Studio
Location: Library 2nd Floor
Phone:.....727-302-6402
Hours: Mon.-Thurs. 7:30 a.m.-9 p.m.
Fri. 7:30 a.m.-4 p.m.
Sat. 9 a.m. - 1 p.m. (LSC), 10 a.m.-1 p.m. (WS)
Computer Labs
Location: Academic Resource Commons - TE 200
Phone:.....727-341-3512

Advising

Location: AD 118
Phone:727-341-4345

Bookstore

Location: SS 104
Phone:.....727-347-0310

Student Services

Admissions, Business Office, Registration,
Student Records
Location: AD 160
Hours: Mon. and Thurs. 8:30 a.m.-7 p.m.
Tues. and Wed. 8:30 a.m.-4:30 p.m.
Fri. 8:30 a.m.-noon
Phone:.....727-341-4733

Career Services

Location: AD 121
Rose Miglino727-341-4640
Jennifer Palmer.....727-341-4358

Clubs/Organizations

Student Life and Leadership
Location: SS 111
Davie Gill:.....727-341-4314
Band/Jazz Ensemble
Cheerleaders
Chorus & Madrigalians
Circle K
Collegiate Music Educators
Engineering Club
Ethics in Action
Friends of Florida Club
Geoscience Club
Harambee (Black Student Union)
High Achievers Club (affiliated with the Student
Support Services Program)
Honors College
International Student Organization
InterVarsity Christian Fellowship
Intramurals
Making Your Radio Active (MYRA)
Medical Club
MIRA Guild
Phi Theta Kappa, Eta Nu Chapter
Student Government Association
Student Republican Club - Political Club
Student Veterans Association
Theater Arts and Production Club
The Tutoring Club

Disabilities Resources

Location: AD 118
Ray Hollowell727-341-4316

Financial Aid

Phone:.....727-791-2485

Food Service

Location: Library

International Programs/Study Abroad

Location: AD 103
Phone:.....727-341-4735

International Student Services

Location: AD 103
Phone:.....727-341-4370

ST. PETERSBURG/GIBBS CAMPUS

Library

Hours: Mon.-Thurs. 7:30 a.m.-9 p.m.
Fri. 7:30 a.m. - 4 p.m.
Sat. 10 a.m. - 5 p.m.

Phone:.....727-341-7199

Lost and Found

Location: SS 111

Phone:727-341-4627

Office of Special Programs

Location: SA 100

Linda Hogans727-341-3542

Parking

Location: Campus Security, SS 112

Phone:.....727-791-2560

Photo ID/Library card

Location: TE 200, AD 121

Phone:.....727-341-4708 or 727-341-4338

Sports

Mark Strickland727-341-4777

Student Support Services

Location: SA 128

Phone:.....727-341-3526

Testing

Location: AD 110

Phone:.....727-341-4637

Veterans Services

Location: AD 120

Larry Hobbs727-341-4271

Volunteer Services

Location: SA 137

Yalonda Tearett727-341-4303

Women on the Way (WOW)

Services provided on these campuses:

Clearwater Campus.....727-791-2634

SPC Midtown727-341-7156

SPC DOWNTOWN

244 Second Ave. N
St. Petersburg

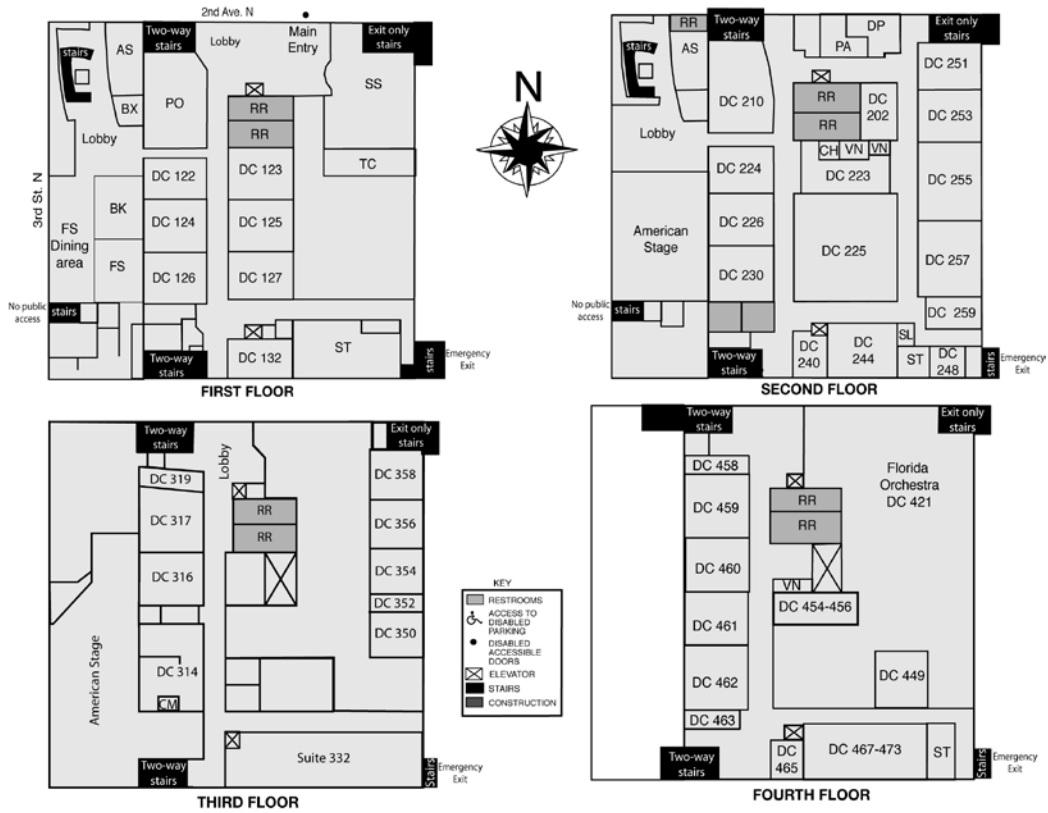

SPC Downtown Room Codes

Classrooms

- DC 122-127 - Classrooms
- DC 224 - Classroom
- DC 226, 230 - Classrooms
- DC 251 - Classroom
- DC 253 - Classroom
- DC 257 - Interactive classroom
- DC 316-317 - Classrooms
- DC 459-462 - Classrooms

Numbered rooms

- DC 132 - GED Program
- DC 202 - Conference room
- DC 210 - Community room
- DC 223 - Student lounge
- DC 225 - Student Life & Leadership, Student Government, Outreach
- DC 240 - Science Prep
- DC 244 - Science Lab
- DC 248 - Staff offices
- DC 255 - Learning Support Commons Open Lab
- DC 259 - Staff offices
- DC 314 - Learning Support Commons Tutoring
- DC 319 - Faculty offices
- Suite 332 - American Stage offices
- DC 352 - Offices
- DC 350, 354, 356 & 358 - Classrooms
- DC 421 - Florida Orchestra
- DC 449 - Call Center
- DC 454-456 - Palladium offices
- DC 458 & 463 - Science Prep
- DC 459 & 462 - Science Labs
- DC 465 - TRS
- DP - Downtown Partnership offices
- DC 467-473 - Faculty Offices

Un-numbered rooms

- AS - American Stage offices
- BK - Book store
- BX - Box office
- DP - Downtown Partnership
- CH - Change machine
- CM - Copy machine
- FS - Food service (cafe')
- PA - Pier Aquarium office
- PK - Student parking
- PO - Provost Office
- RR - Restroom
- SK - Staff parking
- SL - Student lockers
- SS - Student Services: Admissions, Advising, Business office, Career Services, Disability Resources, Financial Aid, Registration, Veterans Services
- ST - Storage
- TC - Testing Center
- VN - Vending

SPC Downtown parking map

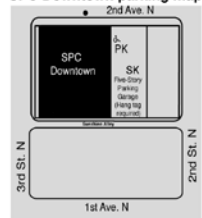

SPC DOWNTOWN

Administration

Provost
Kevin Gordon.....727-344-8062
Associate Provost
Mark Strickland.....727-341-4247

Academic Contacts

Biological Science
Bev Grundset 727-341-4343
Computer and Information Technology
Sharon Setterlind, Dean727-341-4724
Nancy Russell..... 727-791-2530
Communications
Martha Campbell, Dean727-791-2570
Evelyn Finklea.....727-341-4369
Ethics
Barbara Grano 727-341-4313
Humanities and Fine Arts
Jonathan Steele, Dean727-791-5987
Nancy Smith.....727-341-4361
Math
Jimmy Chang, Dean727-341-4605
David Kolonoski727-341-3573
Natural Sciences
John Chapin, Dean727-394-6995
Physical Science
Stephen Andrasik.....727-341-4275
Social and Behavioral Sciences
Joseph Smiley, Dean727-712-5851
Evelyn Finklea.....727-341-4369
A.S. and Certificate Outreach Specialist
Marta Przyborowski.....727-341-7973

Academic Support

Learning Support Commons
Location: Tutoring Center – DC-314
Tutoring in various subjects is provided for SPC
Downtown students. Call for days and times.
Phone:.....727-341-7911
Heather Disler727-344-8065
Computer Labs – Learning Support Commons
Location: Open-use computer labs – DC 255
Hours: Mon.-Thurs. 7:30 a.m.-8 p.m.
Fri. 7:30 a.m.-noon
Sat. 9 a.m.-1 p.m.
Phone:.....727-341-7962

Advising

Location: DC 101
Jerry Cade, Counselor727-341-7966
Brooke Janik, Advisor.....727-341-4248
Roslynn Kearney, Generalist.....727-344-8058
Jeanne Wachtel, Advisor727-341-3010

Bookstore

Barnes & Noble Bookstore
Hours: Mon. and Thurs. 8:45 a.m.-7 p.m.
Tues. and Wed. 8:45 a.m.-5 p.m.
Friday-Sunday Closed
Phone:.....727-821-4273

Student Services

Admissions, Business Office, Registration,
Student Records
Location: DC 101 (lobby)
Hours: Mon. and Thurs. 8:30 a.m.-7 p.m.
Tues. and Wed. 8:30 a.m.-4:30 p.m.
Fri. 8:30 a.m.-noon
Phone:.....727-341-4249

Clubs/Organizations

Student Life and Leadership
Frank Jurkovic.....727-341-4261
Environmental Consulting Society
High Achievers Club (affiliated with the Student
Support Services Program)
Intramural Sports
Phi Theta Kappa Eta Nu Chapter
Psychology Club
Soccer Club
Student Government Association
Student Project

Career Services

Kellie Ziemak.....727-341-4245

Disability Resources

T. J. Williams727-341-7913
(Tues., Wed. and Fri.) - DC 101C

Financial Aid

Phone:.....727-791-2485

Food Service

Nature's Table Café
Location: 1st Floor near 3rd Street entrance
Phone:.....727-822-8690
Vending machines on 2nd and 4th floors

International Programs

Services provided on the St. Petersburg/Gibbs
Campus
Phone:.....727-341-4370

Library

SPC Downtown students have access to any
SPC library, as well as the Nelson Poynter Memorial
Library at USF St. Petersburg. There is an on-site
librarian available in the Tutoring Center, DC 314 on
Mon. 7:30 a.m.-1:30 p.m., Tues. 9:30 a.m.-5:30 p.m.
and Wed. 2:30 p.m. - 9 p.m.
Heather Disler727-344-8065

Lost and Found

Location: DC 225
Phone:727-341-7974

SPC DOWNTOWN

Parking

SPC Downtown students may purchase a parking hangtag on campus on a first come, first served basis to park in the parking garage at 218 Second Ave. N. Hangtags are \$50 per term for spring and fall; \$25 for summer term; and \$25 for evening-only students. Parking Garage Hours: Mon.-Thurs. 6:30 a.m.-10 p.m., Fri. 7 a.m.-5:30 p.m. Students also have the option of metered street parking or paying a fee to park in the BayWalk parking garage.

Phone:727-341-4249

Photo ID/Library card

Location: Campus Security

Phone:727-341-4262

Testing

Phone:727-341-4249

Veterans Services

Location: DC 101F

Jerry Cade727-341-7966

Location: St Petersburg/Gibbs Campus, AD 120

Larry Hobbs727-341-4271

Women on the Way (WOW)

Services provided on these campuses:

Clearwater Campus.....727-791-2634

SPC Midtown727-341-7156

SPC MIDTOWN

1048 22nd St. S
St. Petersburg

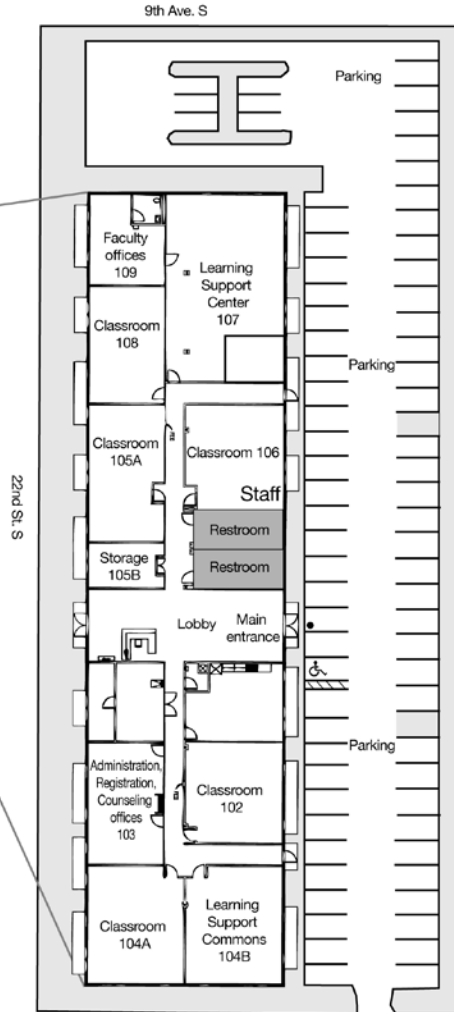
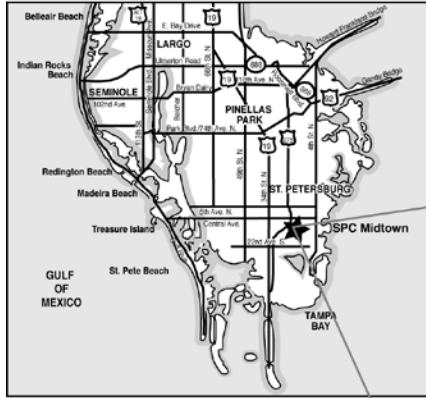

Administration

Provost
Kevin Gordon.....727-344-8062
Associate Provost
Cynthia Jolliff-Johnson.....727-341-7163

SPC Midtown

Main Information.....727-341-7156/58

Academic Support

Learning Support Commons
Location: Tutoring Center – MT 107
Tutoring in various subjects is provided for SPC Midtown students. Call for days and times.
Phone:.....727-341-7158

Computer Labs – Learning Support Commons
Location: Open-use computer labs – MT 107/
Lobby
Hours: Mon.-Thurs. 8 a.m.-10 p.m.
Fri. 8 a.m.-2 p.m.
Phone:.....727-341-7158

Advising

Location: MT 103/105 B
James Johnson, Advisor.....727-341-7155
Hours: Mon.-Wed. 8 a.m.-5 p.m.
Thurs. 9:30 a.m.-7 p.m.
Fri. 8 a.m.-2 p.m.
Lauren Clark.....727-341-7157

Student Services

Admissions, Business Services
(Notary services provided)
Location: MT 103
Hours: Mon.-Thurs. 8 a.m.-5 p.m.
Fri. 8 a.m.-2 p.m.
Phone:.....727-341-7159

Parking

Due to limited space at Midtown, we have partnered with local churches and businesses for additional parking at Royal Theatre (South parking lot only), 1011 22nd St. S; Mt. Zion Progressive MNB Church, 955 20th St. S; and First Mount Zion MB Church, 1121 22nd St. S.

Veterans Services

Services provided on the St. Petersburg/Gibbs Campus
Larry Hobbs AD-120.....727-341-4271

TARPON SPRINGS CAMPUS

600 Klosterman Road
Tarpon Springs

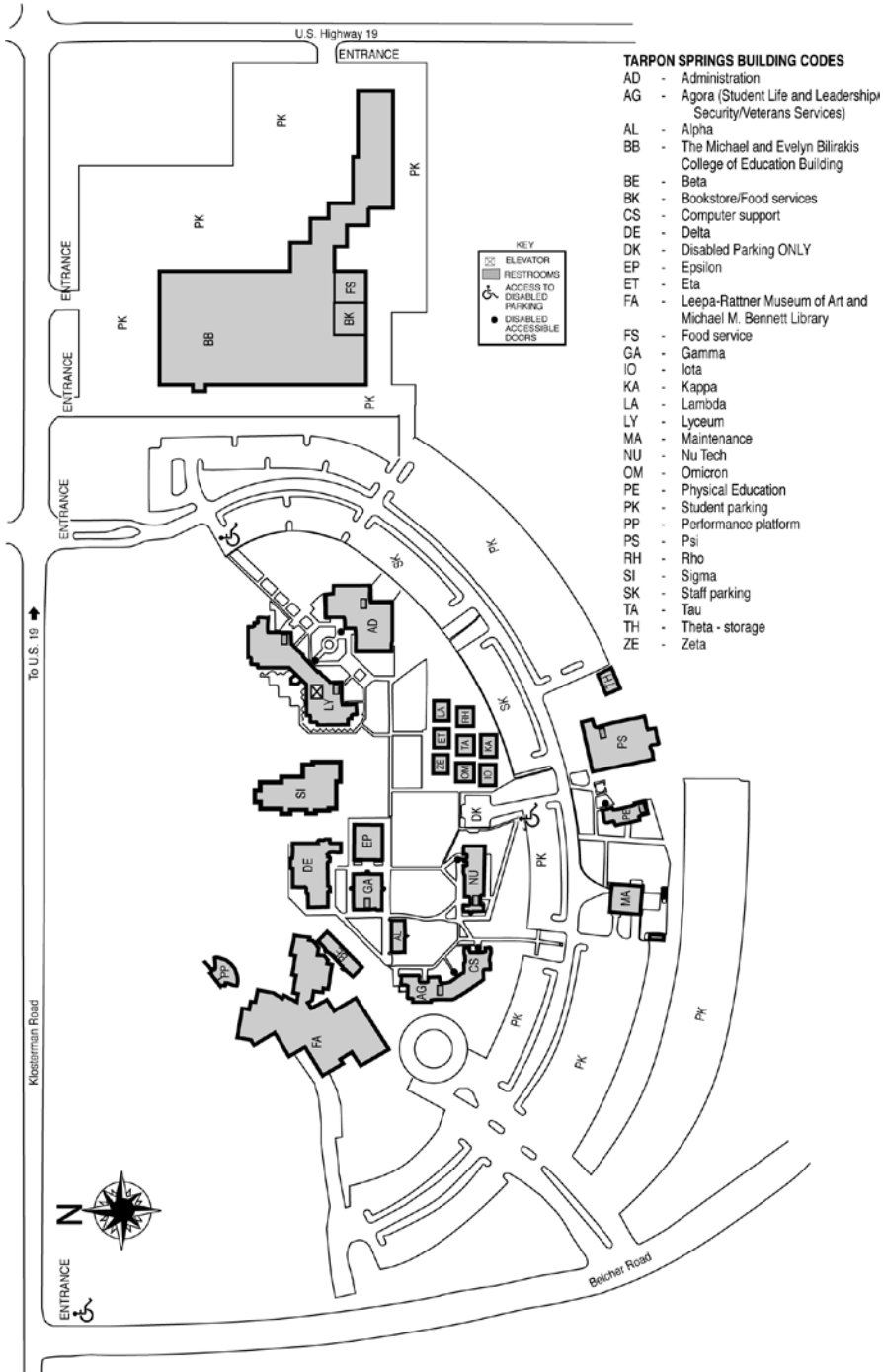

TARPON SPRINGS CAMPUS

Administration

Provost
 Conferlete Carney727-712-5742
 Acting Associate Provost
 Rod Davis.....727-712-5713

Academic Contacts

Business
 Roberto Fernandez.....727-712-5770
 Computer and Information Technology
 Chrissy Risberg.....727-712-5815
 Communications
 Laura Smith.....727-712-5795
 Education
 Kimberly Hartman, Dean727-712-5876
 Ethics
 David Monroe727-712-5404
 Humanities and Fine Arts
 Mark Lulek.....727-712-5717
 Math
 Beth Goodbread727-712-5754
 Natural Sciences
 Meg Delgado.....727-712-5459
 Social and Behavioral Sciences
 Joseph Smiley, Dean727-712-5851
 Social Sciences
 David Liebert727-712-5776
 A.S. and Certificate Outreach Specialist
 Steve Ford.....727-712-5729

Academic Support

Learning Support Commons
 Location: Library
 Phone:727-712-5729
 Computers for Student Use
 Location: Fine Arts Building – Information Commons
 Phone:.....727-712-5729

Advising

Location: Administration Building
 Phone:.....727-712-5761

Bookstore

Location: Olympia Building
 Hours: Mon.-Thurs. 7:45 a.m.-7 p.m.
 Fri. 7:45 a.m.-2 p.m.
 Sat. Closed
 Phone:727-712-5735

Student Services

Admissions, Business Office, Registration,
 Student Records
 Location: Administration Building
 Hours: Mon. and Thurs. 8:30 a.m.-7 p.m.
 Tues. and Wed. 8:30 a.m.-4:30 p.m.
 Fri. 8:30 a.m.-noon
 Phone:727-712-5736

Clubs and Organizations

Student Life and Leadership
 Location: Agora Building
 Erin Senack-Daum727-712-5712
 Art Club
 Creative Community
 Chinese Club
 Entrepreneurship Club
 Free Thinkers Alliance
 Hellenic Society Student Organization
 Latinos United
 Love Serve Live Crew
 Non-Traditional Student Club
 Phi Theta Kappa
 SASA (Students Against Sexual Assault)

Disabilities Resources

Location: Administration Building
 Barbara Thompson727-712-5789

Early College/Dual Enrollment

Location: PS 104
 Clayton Snare727-712-5281

Financial Aid

Phone:727-791-2485

Library

Location: Fine Arts Building
 Hours: Mon.-Thurs. 7:30 a.m.-9 p.m.
 Fri. 7:30 a.m.-4 p.m.
 Sat. Closed
 Sun. noon-7 p.m.
 Phone:.....727-712-5718

Lost and Found

Location: Agora Building, Security Office, AG 132
 Phone:.....727-712-5790

Photo ID/Library card

Location: Agora Building, Security Office, AG 132
 Phone:727-712-5790

Registration

Theresa Kontodiakos727-712-5865

Student Lounge

Location: Agora Building

Testing

Phone:727-712-5761

Vehicle registration/parking

Location: Agora Building, Security Office – AG 132
 Phone:727-712-5790

Veterans Services

Location: Agora Building, SA-105
 Enrique Bernal727-712-5848

Wellness Center

Student Center727-712-5843
 Wellness Center727-712-5710

Women on the Way (WOW)

Students are served by the below campuses
 Clearwater Campus.....727-791-2634
 Seminole Campus.....727-394-6163

VETERINARY TECHNOLOGY CENTER

12376 Ulmerton Rd.
Largo

Main Information..... 727-302-6700

Academic Contacts

School of Veterinary Technology
Richard Flora, Dean..... 727-302-6721
Tricia Gorham, Lead Faculty.....727-302-6733

Advising

Don Keller, Baccalaureate Program
Specialist 727-791-2693

SPC Veterinary Technology Center

Room Codes

- 100 -119 - TBA
- 120, 122 - Restrooms
- 121-132 - TBA
- 134 - Student Work
- 136-139 - TBA
- 139A - Mechanical
- 140 - Electrical
- 141, 143 - Computer Lab
- 142 - Anatomy Lab
- 144 - Lab Storage
- 145 - Collaborative Lab
- 146 - Pathology Lab
- 150 - Custodial
- 151-152 - Restrooms
- 153 - Computer
- 154 - Scrub
- 156 - Surgery
- 157 - Mechanical
- 157A - Electrical
- 157B - Generator
- 158 - Recovery
- 159 - Telecommunications
- 160 - Control
- 160A - Pharmacy
- 161 - Food Prep
- 161A - Food Storage
- 161B - Storage
- 162 - Bath
- 164 - Avary
- 166 - Animal Procedures Lab
- 168 - Lab Prep
- 170 - Radiology
- 172 - Dog Ward
- 173 - Lab Animals
- 174 - Cat Ward
- 175 - Isolation
- 176 - Custodial
- 178, 182 - Storage
- 180 - Oxygen
- 184 - Mechanical

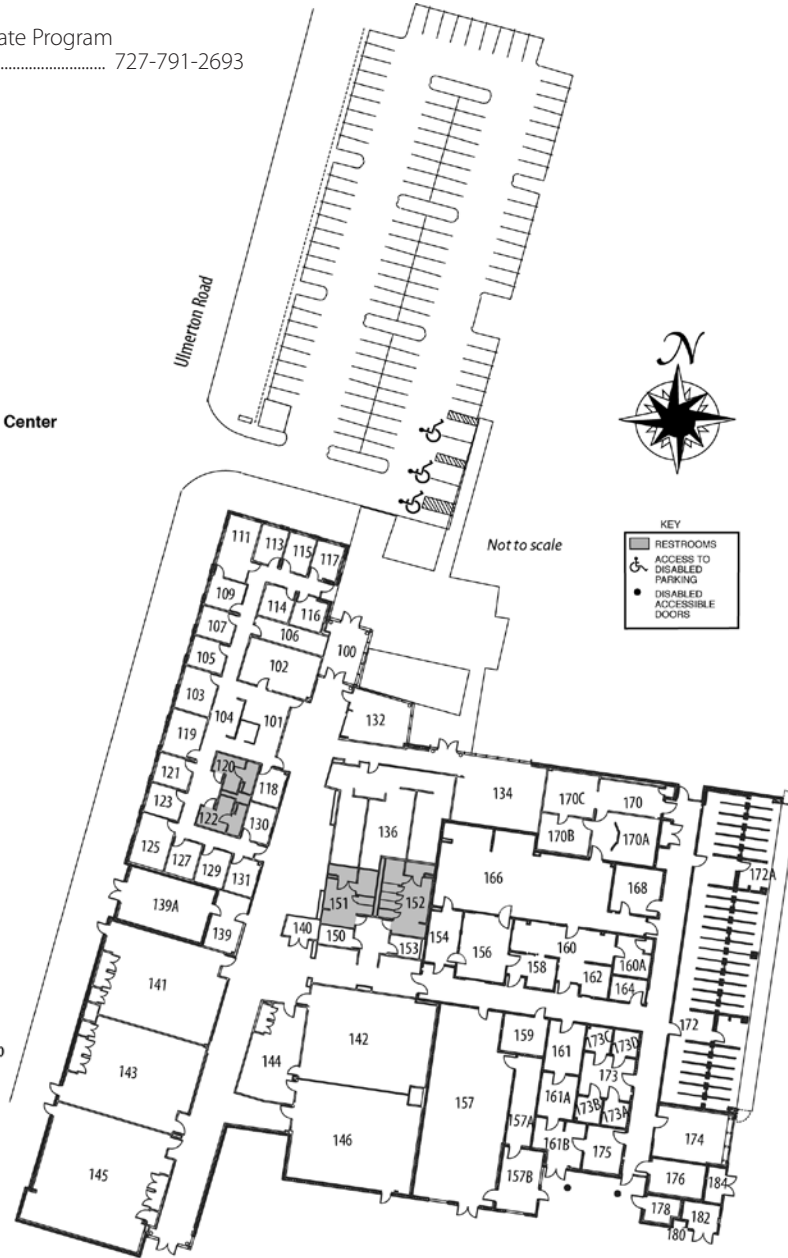

Take your education to a new level

St. Petersburg College offers many options to meet your education needs. Consider your career goals and start planning your path today. Visit www.spcollege.edu/academics for more information and browse by areas of study or by degree type.



Academic Calendar

There are many dates that are important for you to know, such as when classes begin, deadlines for withdrawing, dates of college holidays and final exam schedules to name a few. www.spcollege.edu/calendar

Advising

Academic Advisors will help you get started by walking you through entrance procedures, evaluating placement test scores, reviewing new student orientation information and assisting in course selection based on your career goals. Browse our top FAQs at www.spcollege.edu/askspc or visit www.spcollege.edu/advising to contact an advisor.

Alternative credit options

SPC wants to help you finish your degree. We offer several ways to earn up to 45 college credits for your mastery of subjects, experience, military training, previous education or industry certification. www.spcollege.edu/makeitcount

ANGEL Learning Management System

If you are taking an online or blended course, you need to become familiar with ANGEL, the college's system for online and blended course delivery. ANGEL is also a great way to communicate with your instructors. Visit www.spcollege.edu/eCampus for a variety of ANGEL resources and tutorials. Links to ANGEL can be found on the homepage and at the top of most pages on the SPC website. Your ANGEL username and password are the same as your MySPC user ID and password. angel.spcollege.edu

Computer Labs

Computer labs are available on each campus for all of your academic needs. You must have a MySPC username and password to use the computers. Also, be sure to bring a flash drive to save your work. www.spcollege.edu/computerlabs

Florida Virtual Campus

FLVC is a free online advising website to help students plan and track their education progress from middle school through college. FLVC is sponsored by the Department of Education and the Florida Center for Advising & Academic Support. www.flvc.org

Honors College

St. Petersburg College's Honors College provides an exemplary education and an intellectual community that encourages our most talented and motivated students in creativity and deeper understanding, leadership qualities and critical thinking skills. www.spcollege.edu/honorscollege

Library

Your student ID is your library card and can be used to check out materials or use any of the services our campus libraries provide. Our joint-use libraries on St. Petersburg/Gibbs and Seminole campuses offer the benefits of a public library and college library in one. Use our online library for the convenience of research anytime and anywhere. www.spcollege.edu/libraries

My Graduation Status

This online tool, available in My Learning Plan, shows you in a clear, concise way how much progress you have made and how much needs to be done to complete your degree. www.spcollege.edu/myspc

My Learning Plan

My Learning Plan is an online tool that helps guide you through the requirements for your degree. It gives you up-to-the-minute guidance on how much progress has been made toward your goal and helps you determine the impact of decisions to drop or add courses or change majors. www.spcollege.edu/myplanner

New Initiative Program

The New Initiative Program (NIP) offers academic assistance to pre-health and health education students. www.spcollege.edu/hec/nip

Online Classes

SPC offers hundreds of accredited online college courses in dozens of majors, plus online student support services. Look for online courses as you register. www.spcollege.edu/ecampus

Study Abroad

SPC's study abroad programs allow students to travel to countries like Ireland, Italy and Spain while earning college credit. www.spcollege.edu/studyabroad

Testing

SPC students must pass specific tests to enroll in a program of study and to graduate from some programs. www.spcollege.edu/testing

The College Placement Test (CPT) is used to determine if new students are at college level in reading, English and math. SAT and ACT test scores may be used in lieu of the CPT. See an advisor for details. www.spcollege.edu/CPT

Transcript

Your SPC transcript is the official, permanent academic record that includes the classes you have taken, grades earned for each class, honors and degrees completed. www.spcollege.edu/transcript

Tutoring and Classroom Support (Free)

The Learning Support Commons provides free tutoring in reading, writing and math as well as computer labs and academic resources for students. This support is available whether you are doing well in a class or need some extra assistance. www.spcollege.edu/tutoring

Academic Policies

College preparatory courses

If your College Placement Test scores indicate that some review is needed, you may be required to take college preparatory classes that do not count toward your degree. These courses teach skills in academic fundamentals so you'll be ready to meet the challenge of college-level course work. Students who need college preparatory courses are required to take a College Success Skills course. Free tutoring also is available in the Learning Support Commons at each campus.

Common prerequisites

Students entering college for the first time will have to meet common prerequisite requirements before transferring to the upper-division programs at SPC or a state university in Florida. This means students will not have to take one set of courses to qualify for admission to one university and another set of courses for another university. Limited-enrollment programs will have GPA requirements, but course requirements should be the same throughout the system.

Academic standing policy

A student in **Good Standing** has a minimum cumulative GPA* of 2.0 and a minimum Completion Rate** of 67% for all SPC courses and courses transferred into the college. If these requirements are not maintained, the student will be placed in a Warning status.

A student in **Warning** status has one term to return to the requirements of good standing (see requirements above). If these requirements are not met, the student will be placed in a Probation status.

A student in **Probation** status must maintain a minimum cumulative GPA of 2.0 and a minimum Completion Rate of 67% each term until the student meets the requirements to return to Good Standing. If these requirements are not met, the student will be placed on Academic Suspension.

A student placed on **Academic Suspension** will not be allowed to re-enroll for one term. Before re-enrolling, the student will be required to consult with an advisor and a learning support specialist to complete the terms of a Success Contract. If a student successfully serves the Academic

Suspension and successfully completes the Success Contract, the student will be placed back on Probation status. If a student, upon return to Probation status, fails to meet the requirements of that status, that student will be placed on Academic Dismissal.

A student placed on **Academic Dismissal** will not be allowed to re-enroll for one year. Before re-enrolling, the student will be required to consult with an advisor and a learning support specialist to complete the terms of a Success Contract. If a student successfully serves the Academic Dismissal and successfully completes the Success Contract, the student will be placed back on Probation status.

* Cumulative GPA includes remedial credit hours and transfer credit hours.

** Completion ratio does not include remedial credit hours, but does include transfer credit hours.

Course load

The maximum course load is 18 credit hours in Fall and Spring terms and 12 credit hours in Summer term. SPC has developed the Credit Hour Commitment Model to help students determine the appropriate course load for each term. For every one credit hour enrolled 47 hours of time should be committed. This commitment includes both time spent in class as well as time completing assignments and preparing for coursework. For example a 16-week three credit hour class would require 144 total hours of commitment or 9 hours for each of those 16 weeks. Classes that meet for less than 16 weeks will require larger weekly time commitments. Please see the table below. Students need to consider work, family, and other responsibilities when determining the appropriate course load.

Session Type	Credit Hours	Total Hour Commitment	Weekly Commitment
16-week	3	144	9 hours
10-week	3	144	14.4 hours
8-week	3	144	18 hours
5-week	3	144	28.8 hours

Repeat policy for college credit courses

Students no longer are able to repeat a college credit course for which a grade of "C" or higher has been earned except as an audit by permission of the campus associate provost. Students may repeat courses in which a grade of "D" or "F" has been earned an additional time without penalty. When a student attempts a course for the third or more time, the student will pay the full cost of instruction (defined as the out-of-state tuition and fees rate). A student may appeal the full cost provision on the basis of extenuating circumstances and on an individual basis related to financial hardship. Appeal forms are available in the campus associate provost office. Be advised that on the third attempt, students MAY NOT receive a grade of "I", "W", or "X", but must receive the letter grade earned.

Incomplete policy

Students who are given an incomplete (I) will have until the end of the next full 16-week term to complete the remaining requirements and receive a permanent grade, or the grade will convert to an "F." This means if a student receives an incomplete at the end of Term I, he/she must complete the remainder of the course work by the end of Term II. The only exception to the time frame is for an "I" granted at the end of Term II. In that instance, the student would have until the end of the next 16-week term, which would be Term I of the next academic year. See BOT Procedure 6Hx23-4.20.

Voluntary audit/withdrawal policy

Students must choose the option to audit a course before the end of the drop/add registration period. A student may elect to withdraw voluntarily from a course through the last day to withdraw with a final grade of "W". These dates are listed in the academic calendar on the College's website. A student may elect to voluntarily withdraw from a course after the last day to withdraw with a grade of "W". Students who voluntarily withdraw after the last day to withdraw with a grade of "W" will receive a grade of "WF". See BOT Procedure 6Hx23-4.31.

Register for classes 24/7

Registering for classes online is easier than ever. The My Learning Plan tool in MySPC speeds up the registration process and helps take the guesswork out of deciding what courses to take and when to take them. To register for classes online, login to MySPC and:

- Check your To Do List and view holds that might prevent registration
- Check financial aid status
- Check your student email
- Register for classes

Register as early as possible to get the best schedule. SPC has guaranteed scheduling so no class will be canceled once it is posted. Visit www.spcollege.edu/calendar for registration dates.

Need help?

SPC staff are available to help answer your registration questions. Call SPC's Information Center at 727-341-4772 or visit your campus. Office hours are posted at www.spcollege.edu/hours. The shortest wait times are in the morning. Limited services may be available up to an hour before closing, depending on the number of students waiting. We offer extended hours during peak registration times.

Tuition*

Lower division courses	
In-state, per credit hour	\$105.75
Out-of-state, per credit hour.....	\$380.90
Upper division courses	
In-state, per credit hour	\$116.70
Out-of-state, per credit hour.....	\$419.79

* Tuition and fees are subject to change. The most recent rates are posted at www.spcollege.edu/tuition.

Paying your tuition

Paying your tuition is the last step in registration. It is important that fees be paid by the due date listed on your fee schedule to **avoid being dropped** from your classes. Check MySPC for your due date and payment amount.

- **Residency Status for Tuition**
The tuition you pay is determined by your residency classification. A Florida resident pays a much lower tuition rate than an out-of-state resident. www.spcollege.edu/residency
- **How to pay tuition**
You can pay your tuition online or on campus. www.spcollege.edu/paytuition
- **Tuition Payment Plan**
SPC offers an interest-free tuition payment plan that is affordable and convenient. To qualify for this short-term loan, students pay a percentage up front and an enrollment fee of \$25 to \$35 depending on when they apply. www.spcollege.edu/paymentplan
- **Florida PrePaid Tuition Plan**
SPC accepts Florida PrePaid College funds. Visit our www.spcollege.edu/calendar for deadlines for last day to pay tuition online with Florida PrePaid plans. www.myfloridaprepaid.com
- **Refund policy**
Review details on SPC's refund policy at www.spcollege.edu/refunds.

After you register

- **Get your student ID**
To get your student ID, stop by the nearest campus and bring photo identification (such as a driver's license) and a paid receipt for the current term.
- **Activate your SPC One Card**
If you are 18 years old as of the first day of classes and enrolled in at least one credit hour, you will receive an SPC One debit card for financial aid awards and refunds. www.spcollege.edu/onecard

The college sponsors a variety of special and cultural events throughout the year - many at no charge with your student ID. Check out our events calendar, find out how to get around on campus and get details on clubs and organizations. www.spcollege.edu/studentlife

Visit your campus or contact your Student Life and Leadership Coordinator for information on:

Athletics

SPC has quality intercollegiate athletic teams that compete for conference championships in women's softball, tennis, volleyball and basketball and in men's baseball and basketball. www.spcollege.edu/athletics

Bulletin boards

If you have an event you'd like to promote or an item or service you'd like to sell, contact the campus Student Life and Leadership office for approval to post notices on each site's general-interest bulletin boards. The college reserves the right to restrict commercial postings.

Clubs and organizations

Student clubs and organizations are a great way to get involved. SPC has a variety of academic clubs, musical ensembles and special interest clubs. You can also get involved in your campus Student Government Association. www.spcollege.edu/clubs

Event Calendar

The college sponsors a variety of special and cultural events throughout the year - many at no charge to students. www.spcollege.edu/events

Student lounges

Most campuses have a student lounge, where students can relax, study, watch TV, play billiards, table tennis and other games.

Student publications

Explore SPC Student publications at www.spcollege.edu/publications. The official student newspaper of St. Petersburg College is available at Sandbox.spcollege.edu.

Student recreational activities

SPC sponsors many intramural and recreational activities including basketball, table tennis, bowling, flag football, volleyball and soccer that provide friendly, organized competition. Each student is responsible for accident insurance. Stop by the Student Life and Leadership Office for details.

Volunteer

Become involved in your local community by giving your time, knowledge and experience as a volunteer at St. Petersburg College. Your special touch can make a significant difference in the lives of SPC's students as you assist them in achieving their academic goals - all while doing the things you enjoy! Many fun and exciting opportunities are available to you as part of our volunteer team. www.spcollege.edu/volunteer

Wellness centers

Our wellness centers are workout facilities equipped with Nautilus machines, free weights, StairMasters, exercycles and treadmills. They are free and open to students when they aren't being used by a physical education class. www.spcollege.edu/wellnesscenters

Campus Safety

SPC is dedicated to providing a safe campus environment. If you have concerns about suspicious behavior or an unsafe situation, report it promptly to campus authorities or to College-wide Security at 727-791-2560. In an emergency, call 911 then notify the security office. Visit www.spcollege.edu/safety for:

- Emergency numbers
- Safety Tips
- Crime, fire and OSHA reports
- Sexual offenders list
- Emergency Response Guide
- Emergency Management Plan
- Parking rules

Career Services

SPC Career Services can help you select a career direction and appropriate program of study. We can help with everything from personal assessment, career exploration and decision-making, choosing a matching SPC major, preparing a job search strategy, developing a resume and cover letters, interview preparation and salary negotiation. Learn more about new online career tools at www.spcollege.edu/careerservices

Complaints, grievances and appeals

SPC is committed to providing prompt and fair resolution of all student concerns. Find details on how to express your academic and non-academic complaints and your suggestions at www.spcollege.edu/complaint. You can also participate in student surveys at www.spcollege.edu/surveys.

Disability Resources

Disability Resources carries out SPC's commitment to the open-door concept and equal access to educational opportunities for all qualified individuals with disabilities. Disability Resource Specialists and staff coordinate a variety of services including classroom and testing accessibility, sign language interpreters, assistive technology and training through the Disability Resources office on each campus. www.spcollege.edu/dr

Food services

Nearly every campus has a place to snack between classes. View the campus listings in this guide for details. www.spcollege.edu/campusfoodservices

Graduation

In order to make your degree official for transcripts and future career needs, you must apply to graduate even if you don't plan to attend the graduation ceremony. Review this website for information on preparing to graduate, how to apply and graduation day details. Graduation ceremonies for the college are held three times a year, at the conclusion of the fall, spring and summer terms. www.spcollege.edu/graduation

Housing

There are no residence halls at SPC. However, there are several apartment complexes near each college site. Housing information may be available through the Student Life and Leadership offices on each site.

Insurance

The college does not provide accident or health insurance for students. Optional student insurance may be obtained from a college-approved insurance company at the student's expense. Forms are available in the Student Life and Leadership offices. Certain courses require the student to obtain liability insurance for which a special fee is charged.

Internships

Get real world experience from some of the area's best employees. Learn valuable on-the-job skills and expand your professional network with an internship from SPC's College-wide Internship Office. www.spcollege.edu/studentinterns

International Student Services

We value the intellectual and cultural diversity that international students bring to our campuses. Students who are not U.S. citizens have two options to take classes at SPC. You can come to the U.S. and study on our campus or you can stay in your home country and study online. We work closely with international students to help them succeed by offering assistance with admission, immigration advising, cultural adjustments, involvement in activities and much more. www.spcollege.edu/internationalstudents

Parking

Parking is free in most places at SPC as long as you park in spaces reserved for students. Students at SPC Downtown need to purchase a hangtag to park in the garage. www.spcollege.edu/parking

Student Assistance Program

If you need support, advice or just a friendly ear, help is only a phone call away. SPC is offering this service for FREE to SPC students. www.spcollege.edu/referrals

Student ID/library card

Before you can check out library materials, use a computer lab or work out at any campus wellness center, you need an SPC photo ID. To get your ID, stop by the nearest campus and bring photo identification (such as your driver's license) and a paid receipt for the current session. Distance students should complete the Student ID Request Form found on the Registration Guide of the eCampus website. www.spcollege.edu/studentid

Student Support Services program

Student Support Services is a federally-funded program that helps first generation and low income students graduate from college. www.spcollege.edu/ss

Textbooks

You can purchase new, used or digital books or rent them at bookstores operated on campus and online by Barnes & Noble. You can automatically order your textbooks after you register in MySPC and have them shipped to your home or pick them up at any of the Barnes & Noble bookstores on campus. If you are receiving financial aid and your aid exceeds your tuition and fee charges, you may purchase books and supplies using our Book Line of Credit, a short-term, interest free loan at our campus bookstores. You can also trade textbooks through SPC's Book Swap. www.spcollege.edu/textbooks

Veterans Services

St. Petersburg College has been named one of the top 15 veteran-friendly colleges in the country. Veterans Services specialists will help ease your transition in starting, continuing or resuming your educational pursuit and offer assistance with Department of Veterans Affairs (VA) educational benefits. Veterans Services Centers provide specialized services to Veterans, eligible dependents, active duty servicepersons and members of the Selected Reserve. Currently, more than 1,800 student veterans have made SPC their choice – with more student veterans joining our ranks every day. www.spcollege.edu/veterans

Women on the Way (WOW)

Women on the Way (WOW) assists students entering or re-entering college after an extended period away from academic life. www.spcollege.edu/wow

Not sure how to pay for college?

Financial Assistance Services provides guidance on grants, scholarships, student employment and loans to help pay college expenses. Online student services keep the same hours as you – 24/7. Login to MySPC for instant access to your financial aid information or visit www.spcollege.edu/getfunds for a step-by-step checklist to apply for financial aid and the most up-to-date information on a wide range of topics.

Free Application for Federal Student Aid (FAFSA)

To apply for financial aid, you need to complete a Free Application for Federal Student Aid (FAFSA) at www.fafsa.ed.gov. The information you provide determines whether you qualify for federal and state grants and federal loans. To complete the FAFSA, you will need to get a Federal Student Aid PIN at www.pin.ed.gov

Financial aid contacts

General Questions

Phone: 727-791-2485
Fax: 727-791-2495
TTY: 727-712-5282
Email: askfas@spcollege.edu

Verification

Fax: 727-791-2495
Email: verification@spcollege.edu

Satisfactory Academic Progress

Fax: 727-444-6991
Email: sapappeals@spcollege.edu

SALT

Website: www.saltmoney.org/SPC
Loan Counseling: 877-523-9473, loanhelp@saltmoney.org
Member Support: 855-469-2724, salt@saltmoney.org

Locations/Hours

Financial aid offices are located in the administration buildings on the Clearwater, St. Petersburg/Gibbs, and Tarpon Springs campuses; in the UP building on the Seminole Campus; and the main buildings on the Downtown and Midtown campuses. Hours of service:

Clearwater, St. Petersburg/Gibbs, Tarpon Springs and Seminole campuses

Monday and Thursday, 8:30 a.m.-7 p.m.
Tuesday and Wednesday, 8:30 a.m.- 4:30 p.m.
Friday, 8:30 a.m. – noon

Downtown

Monday, 9a.m.-7 p.m.
Tuesday, 8 a.m.-5 p.m.
Friday, 8 a.m. – noon

Midtown

Wednesday and Thursday, 8:30 a.m.-5 p.m.

Receiving funds

Students begin receiving financial aid refunds at the end of the fourth week of classes of the earliest term they are enrolled in. If you are enrolled only in Express or Second 8-week Mod classes, your financial aid will be refunded at the end of the fourth week of that term. It is the student's responsibility to understand the attendance policies of all courses they are enrolled in. www.spcollege.edu/receivingfunds

Tuition and fees

SPC deducts tuition and fees from your financial aid award directly. If your award is less than the cost of tuition and fees, you must pay the difference by the tuition due date. www.spcollege.edu/paytuition

Book Line of Credit

If your financial aid exceeds your tuition and fee charges, you may charge up to \$800 in books and supplies using the Book Line of Credit (a short-term, interest-free loan) at campus bookstores. The amount of your Book Line of Credit is based on projected financial aid that will be refunded at the end of the fourth week of your classes. Check MySPC to see your individual amount. The bookstore will have your information on file and will apply your available book charges against your tuition account. www.spcollege.edu/bloc

Disbursements

Disbursements occur when SPC receives federal, state or other funds on your behalf. These funds are disbursed to your student account to cover your tuition, fees and Book Line of Credit charges. This is the date you will see in MySPC; however, this is not the date your excess funds are refunded to your SPC OneCard.

Loan disbursements - All loans are disbursed in two payments, even if the loan is for one term. If your loan is for fall and spring, you will receive one half of the loan during the fourth week of classes of each term. If your loan is for one term only, you will receive two payments within that term, the first during the fourth week of your classes and the second at the halfway point of the term.

Refunds

Refunds to your SPC OneCard occur when the amount of the disbursements received on your behalf is greater than the amount owed for tuition, fees and the Book Line of Credit. The excess funds will be refunded to your SPC OneCard based on the choice you made when you activated the card. Refunds begin at the end of the fourth week of your classes. Visit www.spcollege.edu/onecard for refund dates and other details.

Student employment pay

Students working through student employment programs of Federal Work Study, America Reads, America Counts or Student Assistants will receive their paychecks bi-weekly through their supervisor or directly deposited into their bank accounts.

Satisfactory Academic Progress

Federal regulations require that all students who receive financial aid demonstrate that they are moving through their academic program at a reasonable rate and are making progress toward their degree in order to continue receiving financial aid. www.spcollege.edu/sap

Withdrawing from class

CAUTION: If you are a financial aid recipient and are thinking about dropping your classes or withdrawing from the college, please consult a financial aid counselor first to be sure you understand the consequences of this decision. www.spcollege.edu/withdrawal

The most up-to-date compliance information is available on the college website, www.spcollege.edu. Access to information about Board of Trustees rules, procedures, safety and security data and other compliance and legal regulations can be accessed at www.spcollege.edu/legal or www.spcollege.edu/boardrules.

Links to specific information about the following topics can be found at www.spcollege.edu/studentrights:

- Academic Honesty Guidelines
- Accreditation
- Access to SPC Campuses
- Acquired Immune Deficiency Syndrome (AIDS) Information
- Alcohol and Illegal Drugs
- Annual Campus Security/Crime Update
- Articulation Agreement
- Catalog Year vis-à-vis College Entrance and Allied Health Programs
- Complaints/Concerns/Suggestions
- Complying with Copyright Law
- Copyright Infringement Policies
- Cost of Attendance
- Crime Information and Statistics
- Course Repeat Policy
- Disability Resources
- Disciplinary Procedure
- Discrimination Grievance Procedure
- Drug Alcohol Abuse Prevention
- Fire Safety Reports
- Florida Virtual Campus (FLVC)
- Gender Equity in Intercollegiate Athletics
- General Education Requirements
- Graduation and Transfer Rates
- Gramm Leach Bliley Act
- Incomplete Grades and Procedures
- Information Technology Acceptable Use
- Intercollegiate Athletics
- Mass Notification
- Meningococcal Meningitis & Hepatitis B
- Missing Person Policy
- Net Price Calculator
- Parking
- Peer to Peer File Sharing
- Placement Rates
- Possession of Weapons
- Preventative Measures Against Rape
- Reporting a Crime/Important Numbers
- Retention Rate
- SARS Basic Information
- Security Awareness/Tips
- Sexual Harassment Awareness, Definitions and Facts
- Sexual Misconduct Definitions and Facts
- Student and Student Organization Regulations
- Student Body Diversity
- Student Ombudsman Office
- Student Records Rule
- Threat Assessment
- Time Warnings and Emergency Notifications
- Transfer of Credit Policy
- Voluntary Audit/Withdrawal Policy
- Voter Registration
- Warning/Probation/Suspension/Dismissal Policy

SPC Complaint Policy

St. Petersburg College is always looking for ways to improve. We are committed to providing prompt and fair resolution of all student concerns and strive to make the process of communicating such concerns as easy as possible. We take these concerns very seriously and the information below outlines this process. Examples of student complaints related to this policy include matters relating to College facilities (services received, facilities, etc.) or other services such as the College bookstore, student services or campus cafeteria.

To make a formal complaint:

1. Access the College's Student Complaint website www.spcollege.edu/complaint.
2. Complete and submit the online complaint form. If a student is in need of accommodations, a college employee may submit the form on their behalf.
3. Your complaint will be routed to the appropriate department and you will receive confirmation of receipt within 24 hours (not counting days the college is closed) that the complaint has been received.

4. The complaint will be processed and you will be notified of the resolution in writing.

Academic appeals and student grievances are not considered complaints and should be lodged through the formal student grievance/appeal process found in the SPC Board of Trustee Procedure (P6Hx23-4.36). If you have an academic grievance or appeal, please utilize this procedure.

Conduct

SPC students are expected to conduct themselves in a manner that will reflect credit to the college, the community and themselves. Each student, by registering, assumes the responsibility to become familiar with and abide by the general regulations and rules of conduct outlined at www.spcollege.edu/studentconduct.

Discrimination

SPC does not tolerate discrimination in its employment practices or in the admission and treatment of students. All SPC employees and students are responsible to adhere to SPC's discrimination policy. Violators are subject to disciplinary action, which may include reprimand, suspension or dismissal. For information on types of discrimination and reporting information visit www.spcollege.edu/discrimination.

Safety Reports

St. Petersburg College's Security Department is dedicated to the safety of students, staff and visitors by providing quality services and information to help make the time that you spend at SPC safe and enjoyable. Visit www.spcollege.edu/campusafety for current reports on:

- Criminal activity on campus/neighborhood area
- Fire Report
- Sexual Offenders List
- OSHA Report

Sexual Harassment

St. Petersburg College has a strong commitment to keeping its workplaces and classrooms free from sexual harassment. The responsibility for doing so rests with each member of the college community. Get details on what constitutes sexual harassment, frequently asked questions and reporting contacts at www.spcollege.edu/sexual_harassment.

Sexual Misconduct

It is St. Petersburg College's goal to prevent sexual assault (rape) and sexual harassment on all of its campuses and other facilities. For information on definitions and facts about sexual misconduct, preventive measures you can take, procedures for reporting, penalties, victims' rights and more, visit www.spcollege.edu/sexual_misconduct.

Student Records

Students and eligible parents and guardians have the rights as afforded by the Family Educational Rights and Privacy Act (FERPA) to:

- Inspect and review education records within 30 days of the day the college receives a request for access
- Request the amendment of a student education record the student believes is inaccurate
- Consent to disclosures of personally identifiable information contained in the student's education records, except to the extent that FERPA authorizes disclosure without consent
- Obtain a copy of the college's policy on student records from the office of the Associate Provost on each campus, center or site.
- Restrict the release of college directory information. This can be done in the "My Information" section of MySPC.
- File a complaint concerning any and all alleged failures of a state college to comply with the requirements of FERPA with the Family Policy Compliance Office, U.S. Department of Education, 400 Maryland Avenue SW, Washington, DC 20202-5901.

For more information on FERPA, what constitutes directory information, and how to exercise your right to restrict access to it, visit www.spcollege.edu/FERPA.

ADDITIONAL ONLINE RESOURCES

Board Rules	www.spcollege.edu/boardrules
Career tools.....	www.spcollege.edu/careertools
College Catalog.....	www.spcollege.edu/catalog
Faculty and Staff Directory.....	www.spcollege.edu/contactdirectory
MySPC Guide	www.spcollege.edu/myspc
Online tools	www.spcollege.edu/onlinetools
Readmission	www.spcollege.edu/readmission
Resource Guide.....	www.spcollege.edu/resourceguide

Within Reach

**From combat to college,
St. Petersburg College
makes the transition easy.**



Among the top 15
military friendly

SPC St. Petersburg
College
VETERANS SERVICES

www.spcollege.edu/veterans | 727-302-6400



13-0170-01

Within Reach

St. Petersburg College

SPC